

Pitcher Pump How to replace the Leather Cup

2/27/20

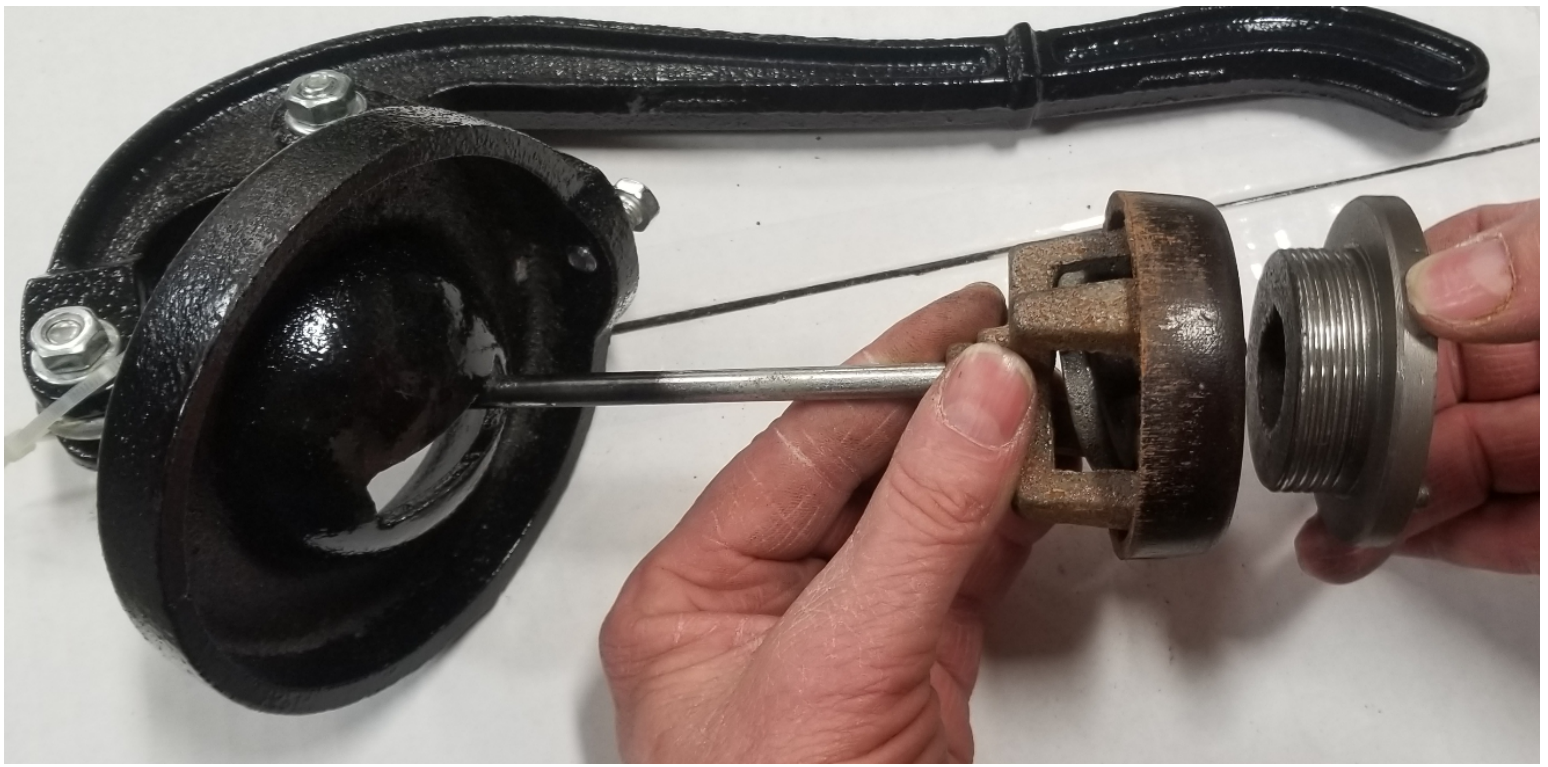



The above 3 pictures are how to remove the old leather cup to replace it with a new one.

****NOTICE**** *The pictures above show this change with a new pump that was on the shelf. In replacing this on a used pump, it is likely that rust has become a factor and proper lubricants and tools may be needed, but be mindful not to do a lot of forcing as the material is made of cast and is prone to crack or break.*

MAINTENANCE

Replacing the Cup Leather

- Loosen the hexagon bolt (8) and lift the plunger assembly out of the pump
- Unscrew the cup leather holder (13)
- Remove old cup leather (12) and put on new cup leather
- Screw leather cup holder (13) back into original position
- Reinstall plunger assembly and top cap (9)
- Insert hexagon bolt (8) and tighten

Replacing the Valve Leather

- Unscrew the hexagon bolts (15) & flat washers (5)
- Remove the pump body (14) from the flange (20)
- Lift the valve leather assembly from the flange (20). Unscrew hexagon nut (19) and flat washer (6). Remove the valve leather (18) from weight (17). Attach new valve leather to weight (17); tighten hexagon nut (19) and flat washer (6).
- Before placing valve leather assembly on flange (20), clean the flange by removing dirt/debris that could be left over
- Reattach the valve leather assembly of hexagon nut (16), weight (17), valve leather (18), hexagon nut (19), and flat washer (6) on the flange (20).
- Reattach the pump body (14) to the flange (20) by tightening hexagon bolts (15) & flat washers (5). Make sure to soak the valve leather before next use.

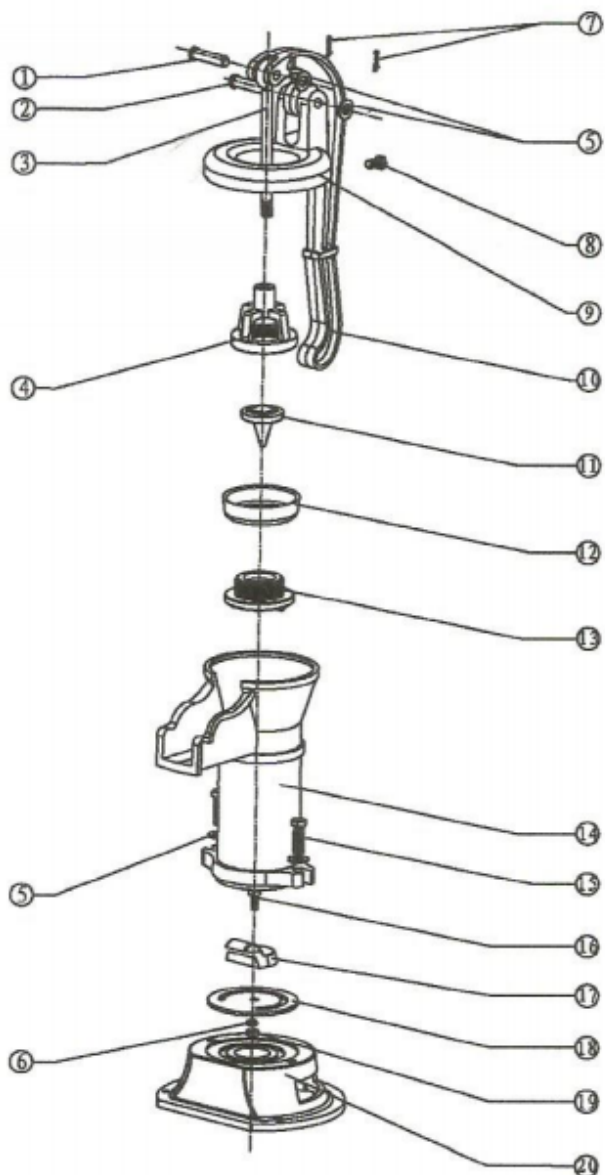

1	Pin
2	Pin
3	Lift Rod
4	Plunger Valve Cage
5	Flat Washer
6	Flat Washer
7	Cotter Pin
8	Hexagon Bolt
9	Top Cap
10	Handle
11	Plunger Valve
12	Cup Leather
13	Cup Leather Holder
14	Pump Body
15	Hexagon Bolt
16	Hexagon Bolt
17	Weight
18	Valve Leather
19	Hexagon Nut
20	Flange