

FOLDING COOLER TABLE ASSEMBLY & SET-UP INSTRUCTIONS

Step by step instructions:

Step 1: Remove Station from the box and position it on the ground as illustrated below.

Open up each leg set and lock into place.

(MAKE SURE LEGS ARE COMPLETELY LOCKED IN POSITION BEFORE USING!)

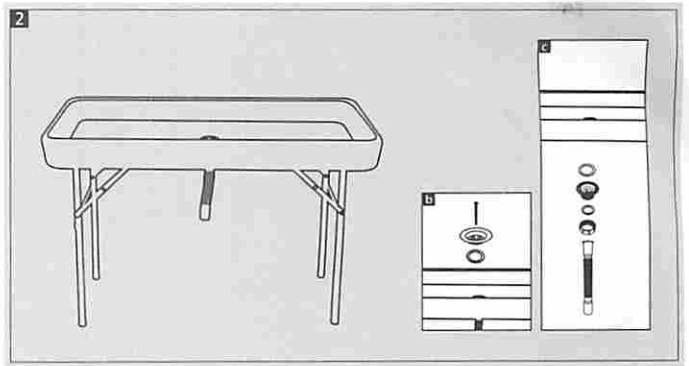
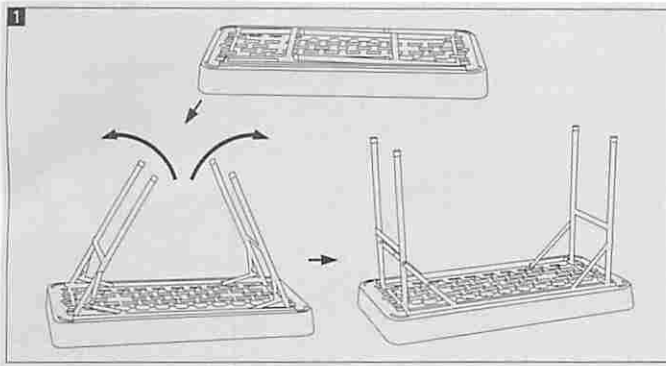

Step 2: Drain Assembly.

b) Drain Connection: The metal drain, Screw and rubber washer are placed on the station's top side.

c) Drain Connection: The rest of the components are placed under the station's top side. (see diagram)

Larger View:

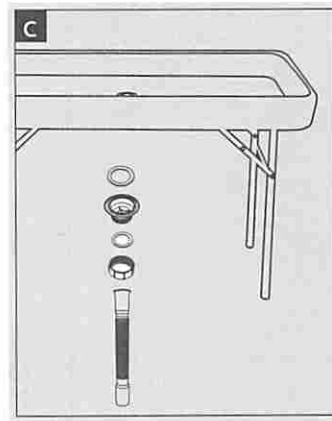
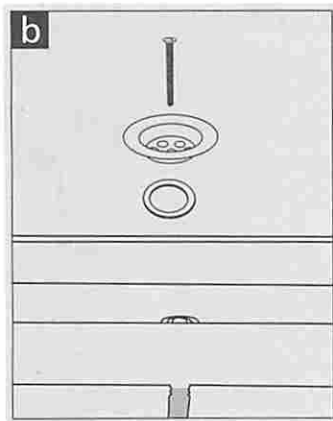

* Table skirt optional (If you buy it, assembly as below)

1: Stick 6pcs velcro as shown in figure 1.

2: Cover the skirt along the table edge as shown in figure 2.

