

# Jack Replacement Quick-Reference Guide

**NOTES:** This Quick Reference Guide is not intended to supplement your original jack instruction sheet. This guide is only intended to help identify your jack for purposes of service and part replacement.

While servicing your jack, make sure it is not under load.

Replacement parts are intended for worn jack parts. If your jack has been damaged, replace it to prevent unsafe conditions.

## Help us help you!

To ensure you receive the most accurate, prompt service possible, collect as much of the following information as possible before calling. If more than one item in a group seems to fit your jack, note all that apply and what about your jack that makes it fit that category. Some helpful pictures are shown at the bottom of the next page.

**Jack Series and Capacity** (Available on product label or in stamped marking)

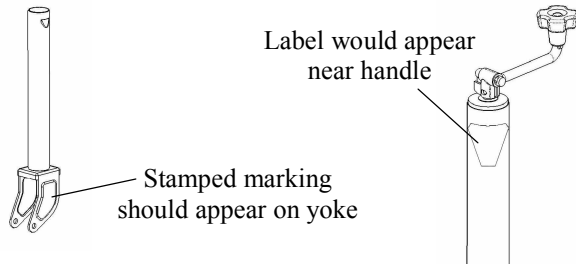

**Plunger Pin Size** (Available by inspection, not a feature on all jack models)

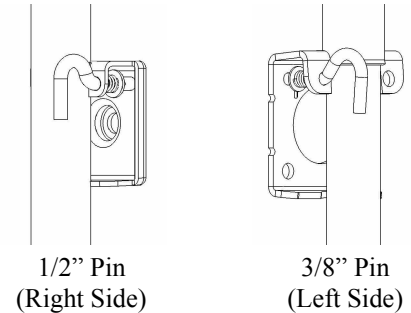

**Handle Style** (Available by inspection)

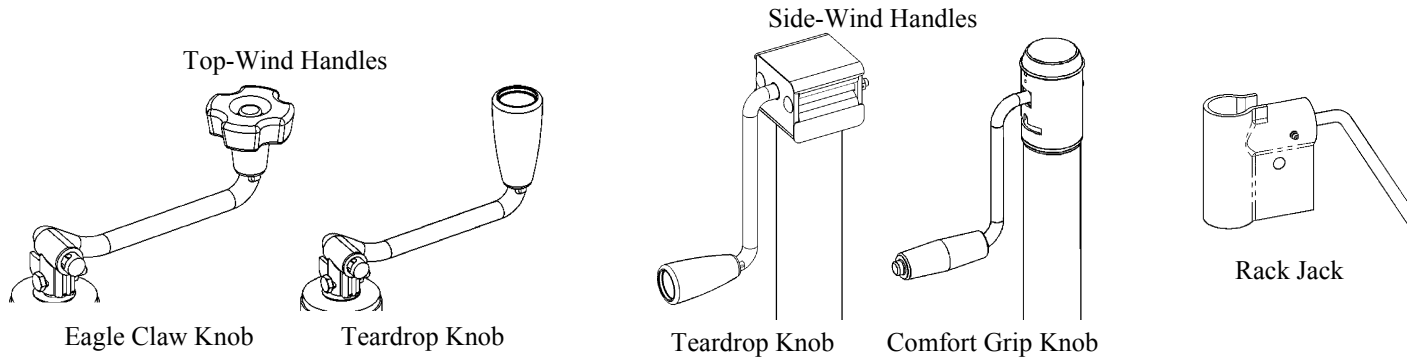

**Mount Type** (Available by inspection. Note if your mount is welded or bolted to your trailer tongue.)

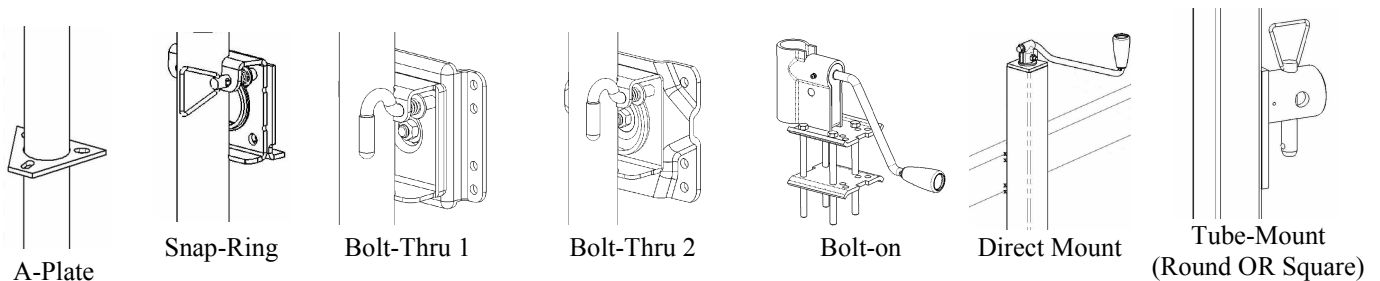

**Foot/Wheel Type** (Available by inspection)

Removable Wheel  
(Wheels may also be fixed to the jack)

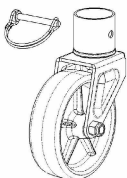

Removable Foot  
(Feet may also be fixed to the jack)

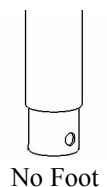
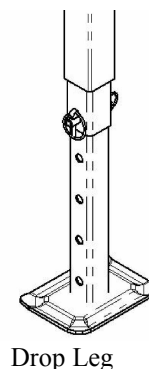
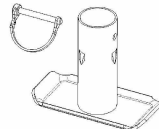

## Some Examples of whole jacks are below

Top-Wind,  
Eagle Claw Knob,  
1/2" Plunger Pin,  
Snap-Ring Mount,  
Fixed Regular Foot

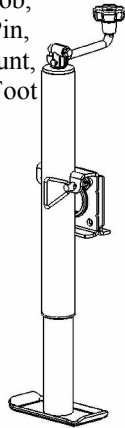

Side-Wind,  
Teardrop Knob,  
Internal Gearbox,  
1/2" Plunger Pin,  
Bolt-Thru I Mount,  
No Foot

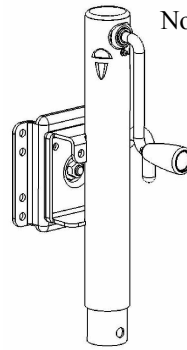

Side-Wind,  
Teardrop Knob,  
External Gearbox,  
Tube Mount,  
Fixed Large Foot

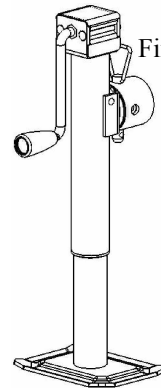

Top-Wind,  
Eagle Claw Knob,  
A-Plate,  
Removable Wheel

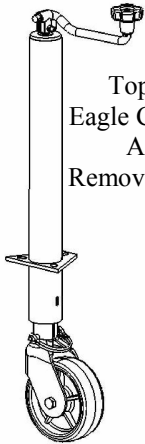

Rack Jack,  
Teardrop Knob,  
Bolt-on

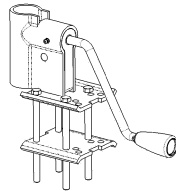

### WARNING

**Failure to follow these warnings and instructions may result in property damage, serious bodily injury, and/or death.**

- Purchaser/owner must ensure that product is installed according these instructions. Purchaser/owner must not alter or modify product. Negligence may result in property damage, bodily injury, and/or in death.
- Operator and bystanders should never position any part of body under any portion of this product or the load being supported.
- Fully retract and rotate jack before towing.
- When using the drop foot or drop leg, make certain the supplied pin is fully inserted through both sides of the inner tube and the drop tube before using the jack.
- If using optional drop foot or caster, always remove drop foot or caster before towing to maximize ground clearance.
- This product is not intended to be used as a transport device for the implement it is attached to. Minimize movement of implement while jack is under load.
- Do not allow children to play on or around this product or the load being supported.
- Secure the load, vehicle and trailer from rolling (by blocking wheels) when operating jack or coupling trailer.
- Never exceed maximum rated capacity. Refer to stamped markings or decals on product to obtain rated capacity. If uncertain, contact Cequent Trailer Products at 800-604-9466 or [www.cequentgroup.com](http://www.cequentgroup.com).
- These jacks are designed for vertical loading. Excessive side forces may cause jack failure and must be avoided.
- Before manually moving trailer, crank to lowest position.
- If this product has a pivot tube mount, make certain the pivot pin is fully inserted through both sides on the pivot tube and the pivot mount.
- If this product is a swivel jack, lock the plunger pin into a hole in the mounting bracket before raising or lowering the tongue.
- Before installing the snap ring, inspect the snap ring groove and remove any debris. Seat the snap ring fully into the groove.
- Do not attempt to weld "Bolt-On" brackets or straps to the tongue. Special brackets are available for "Weld-On" applications.
- If this product has a drop foot or drop leg, never attempt to adjust the drop foot or drop leg when there is any load on the jack. Doing so could cause the trailer to move suddenly.
- If this product is a rack jack, do not raise the gear housing above inner tube.
- Always replace bent, broken, or worn parts before using this product.
- These jacks are designed for mounting to rectangular tongues only. This product is not designed for mounting to round tongues.
- All welding must be performed by an AWS certified welder.

# Assembly Quick-Reference Guide

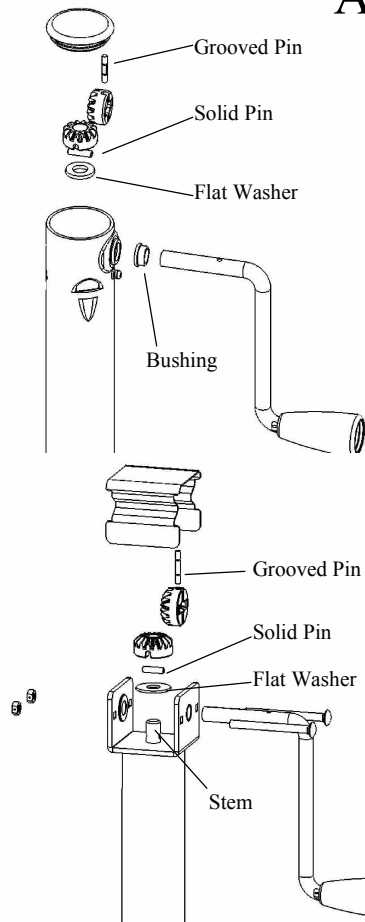

## **Side-Wind Jack Assembly:**

- 1) Carefully remove all parts from the gearbox. The grooved pin is very secure in place and you may need to rotate the jack handle to reveal and remove it.
- 2) Place the flat washer over stem at the bottom of the gearbox.
- 3) Place the solid pin through the hole in the stem and place the gear over the solid pin so that the solid pin rests in the slot on the gear that does NOT go across the entire gear. The lower gear should be the larger of the two gears if the gears are a different size.
- 4) If you have an internal gearbox, install the bushing from inside the jack tube.
- 5) Insert the handle through the bushing and the second gear. Be sure the gear teeth are fully engaged and the handle is sticking out the far side of the jack after this step.
- 6) The grooved pin must now be inserted through the second gear and the handle. It may be necessary to rotate the handle 1/4 turn to expose the hole in the handle. The groove pin will fit very tightly and should be installed carefully to avoid damage to the jack body. Make sure the pin is centered in the handle to ensure smooth cranking.
- 7) Re-install the cap with even pressure, or with the bolts and nuts as it was removed.
- 8) Be sure the jack is assembled properly and functions as new before using it to support a load.

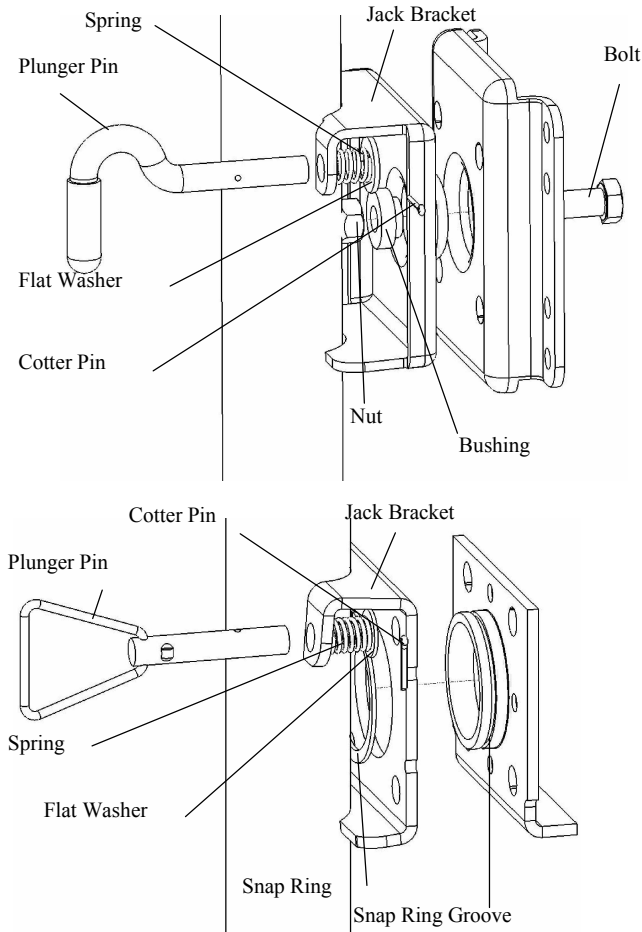
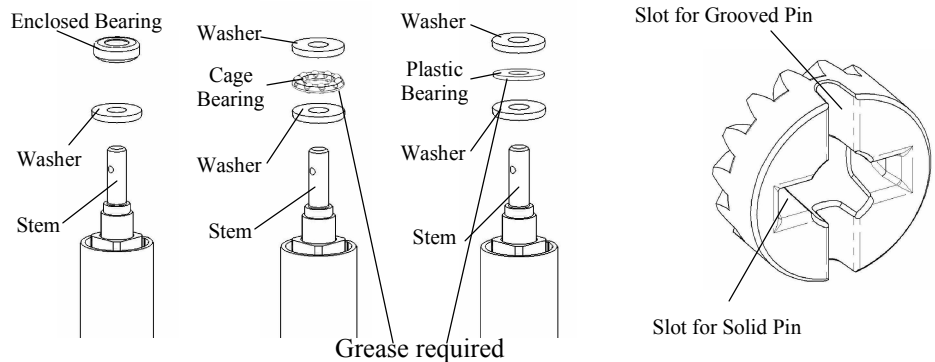

## **Bolt-Thru Assembly:**

Place the jack bracket into the recessed opening of the mount. Place the small end of the bushing into the jack bracket and onto the bolt. Tighten until there is little movement in the bushing.

## **Snap Ring Assembly:**

Place the jack bracket over the mount so that the snap ring groove is reachable on the inside of the jack bracket. Insert the snap ring into the groove. Be sure the snap ring is fully seated in the groove.

## **Plunger Pin Assembly:**

First select the appropriate hole for the plunger pin. When viewing the jack from the crank side, 3/8" pins fit into the left hole, 1/2" plunger pins fit into the right hole. Also check that the mating bracket has the correct size holes in it.

- 1) Start the plunger pin through the jack bracket and place the spring and washer on the plunger pin before fully inserting the plunger pin through the jack bracket.
- 2) The spring and washer must be compressed to allow the cotter pin to be properly inserted into the plunger pin.
- 3) Be sure the jack is assembled properly and functions as new before bending the cotter pin to secure the plunger pin assembly and before using it to support a load.