

1500LB STEEL DUMP CART



Instruction & Assembly

SAVE THESE INSTRUCTIONS FOR FUTURE REFERENCE

Table of Contents

General Warnings and Rules	3
Hazard Signal Word Definition	4
Controls and Features Identification.....	5
Component & Hardware.....	6, 7
Assembly Instructions	8, 9 10, 11, 12
Operation Instructions	13
Maintenance and Storage	14
Specification.....	15
Parts Drawing & Parts List	16, 17



GENERAL WARNINGS



READ and UNDERSTAND this manual completely before using Utility Dump Cart.

Operator must read and understand all safety and warning information, operating instructions, maintenance and storage instructions before operating this equipment. Failure to properly operate and maintain the utility dump cart could result in serious injury to the operator or bystanders.

Operation Warnings

- Do not at any time carry passengers sit or stand on the cart.
- Do not allow children to play on, stand upon or climb in the cart.
- Always inspect the cart before using to assure it is in good working condition.
- Replace or repair damaged or worn parts immediately.
- Always check and tighten hardware and assembled parts before operation.
- Do not exceed equipment maximum load capacity of 1500lb.
- Avoid large holes and ditches when transporting loads.
- Be careful when operating on steep grades (hill) the cart may tip over.
- ALWAYS operate at reduce speed in rough terrain, along creeks, ditches and on hillsides.
- Do not operate close to creeks, ditches and public highways.
- To avoid personal injury and/or equipment damage DO NOT EXCEED 10 MPH.
- Always use caution when loading and unloading the cart.
- Only tow with recommended vehicles (Lawn/Garden Tractors and ATVs).

Crush and Cut Hazards

- Always keep hands and feet clear from moving parts while operating the equipment.
- Always clear and keep work area clean when operating.
- Always wear safety gear, eye protection, gloves and work boots when operating the dump cart.



WARNING

The warnings, cautions, and instructions outlined in this instruction manual cannot cover all possible conditions or situations that may occur. It must be understood by the operator that common sense and caution are factors which cannot be built into this product and must be supplied by the operator.

Assembly Is Required

This product requires assembly before use. See "Assembly" section for instructions. Because of the weight and/or size of the utility dump cart, it is recommended that another adult be present to assist with the assembly. **INSPECT ALL COMPONENTS** closely upon receipt to make sure no components are missing or damaged.

Hazard Signal Word Definitions

	<p>This is the safety alert symbol. It is used to alert you to potential personal injury hazards. Obey all safety messages that follow this symbol to avoid possible injury or death.</p>
	<p>DANGER indicates an imminently hazardous situation which, if not avoided, will result in death or serious injury.</p>
	<p>WARNING indicates a potentially hazardous situation which, if not avoided, could result in death or serious injury.</p>
	<p>CAUTION indicates a potentially hazardous situation which, if not avoided, may result in minor or moderate injury.</p>
	<p>CAUTION used without the safety alert symbol indicates a potentially hazardous situation which, if not avoided, may result in property</p>

ABOUT YOUR UTILITY DUMP CART

This utility dump cart has a roughed steel construction and is designed to carry a wide range of materials. The dump cart will easily haul up to 1500lbs of tools, firewood, animal feed, trash, landscaping materials, cement or anything else that needs to be moved. Easy to use removable tailgate makes loading and un-loading fast and convenient. Never exceed the rated load capacity of 1500lbs when operating the utility dump cart.

Technical specifications on the utility dump cart are provided in the "Specifications" section of this manual.

Controls and Features Identification

Read this owner's manual before operating the equipment. Familiarize yourself with the location and function of the controls and features. Save this manual for future reference.



- 1) **Removable Tailgate** – Push up to remove for loading and unloading.
- 2) **Tires / Wheel** – Do not exceed the recommended rate 30 PSI.
- 3) **Hitch** – Pin-type design use only with approve vehicles.
- 4) **Utility Cart Box** – Do not exceed rated load capacity 1500lb.



CAUTION

Read and follow all instructions for assembly and operation. Failure to properly assemble this equipment could result in serious injury to the user or bystanders, or cause equipment damage.

UTILITY DUMP CART COMPONENT PARTS AND ASSEMBLE.

Take all parts out of the shipping crate and inspect components to ensure there are no missing pieces before starting to assemble the utility dump cart follow steps 1 through 13.

TOOLS REQUIRED

- Pliers
- Screw Driver
- 10mm Wrench
- 14mm Wrench

Component Parts

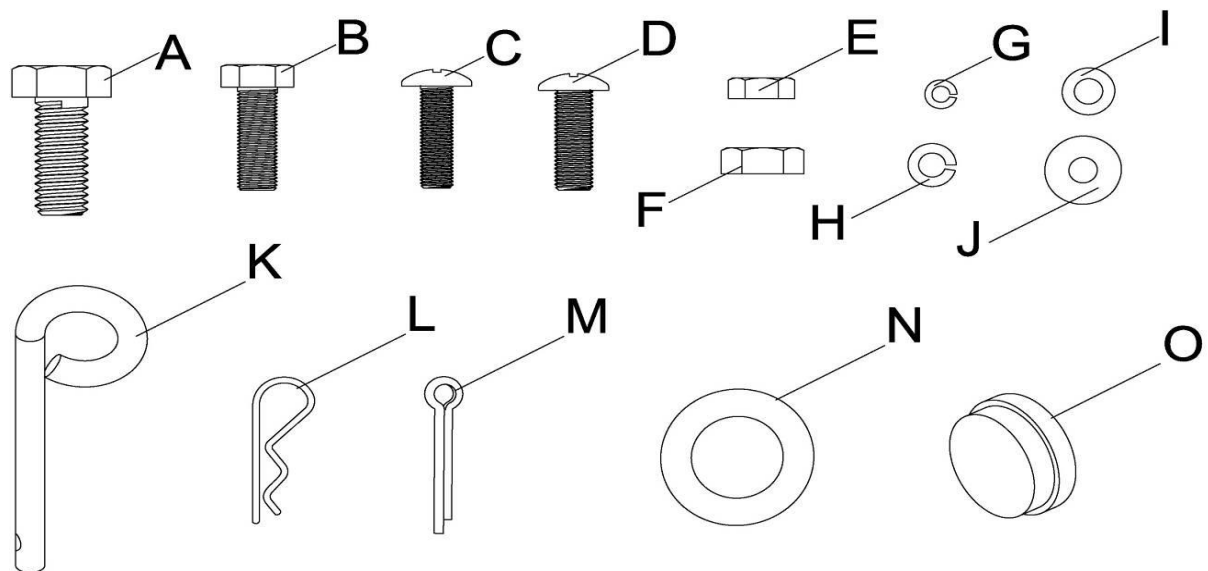

REF#	Description	QTY	REF#	Description	QTY
A	M8x20 Hex Bolt	10	I	Ø6 Flat Washer	51
B	M6x20 Hex Bolt	2	J	Ø8 Flat Washer	32
C	M6x16 Round Slotted Bolt	49	K	Lock Pin	1
D	M8x16 Round Slotted Bolt	22	L	R Pin	2
E	M6 Nut	51	M	Cotter Pin	2
F	M8 Nut	32	N	Large Washer	4
G	Ø6 Lock Washer	51	O	Wheel Hub Cap	2
H	Ø8 Lock Washer	32			

Note: you may have extra nuts & bolts when finished.

Component Parts

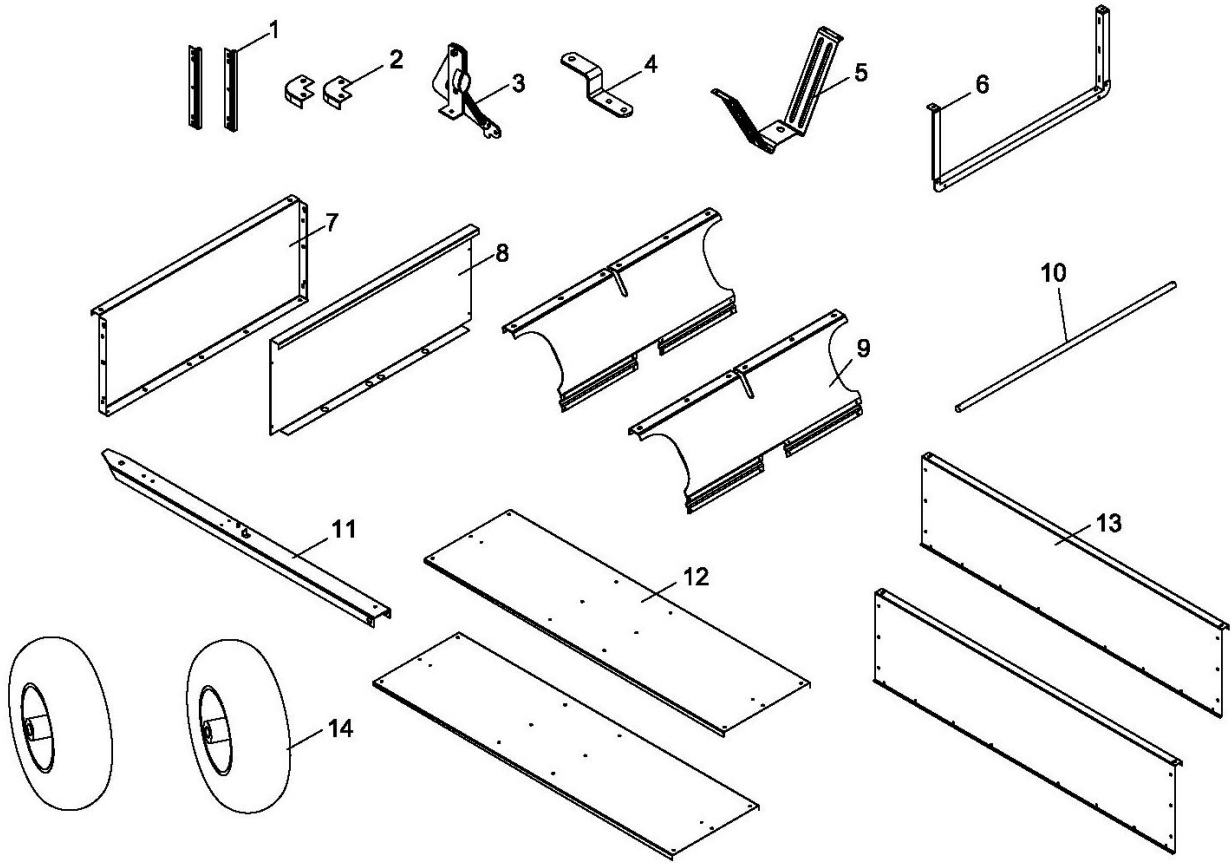

REF#	Description	QTY	REF#	Description	QTY
1	Tailgate Holding Guide	2	8	Tailgate	1
2	Corner Cap	2	9	Wheel Support	2
3	Release Latch	1	10	Wheel Axle	1
4	Hitch Bracket	1	11	Hitch Tongue	1
5	Stand Bracket	1	12	Bottom Panel	2
6	Tailgate Brace	1	13	Side Panel	2
7	Front Panel	1	14	Pneumatic Wheel	2

Assembly Instructions

STEP 1: Side Panel Assembly

1. Attach to the side panels to each of the bottom panels using the M6x16 Round Slotted Bolts, Ø6 Flat Washer, Ø6 Lock Washer and M6 Nut and tighten.

Hardware Needed:

- 18 - M6x16 Round Slotted Bolt
- 18 - Ø6 Flat Washer
- 18 - Ø6 Lock Washer
- 18 - M6 Nut

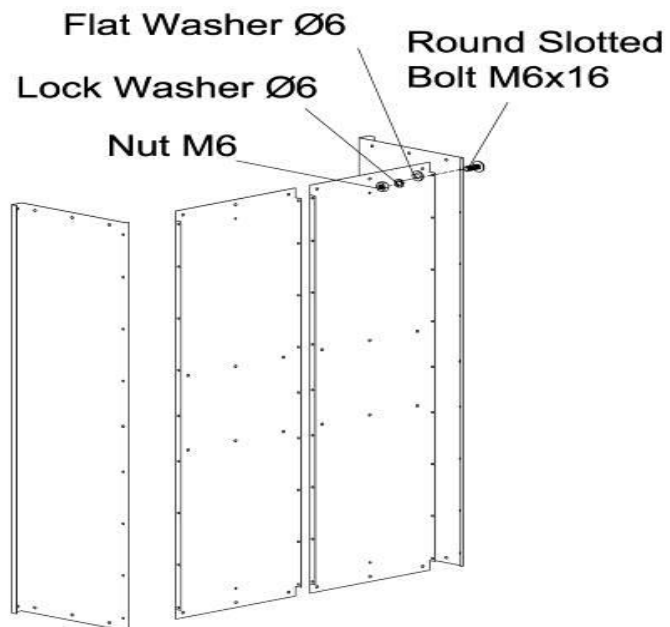

Step 2: Bottom Panel Assembly

1. Stand the cart box upright on a level surface. Connect the center panels together using M6x16 Round Slotted Bolts, Ø6 Flat Washer, Ø6 Lock Washer and M6 Nut. Loosely tighten bolts.

Hardware Needed:

- 9 - M6x16 Round Slotted Bolt
- 9 - Ø6 Flat Washer
- 9 - Ø6 Lock Washer
- 9 - M6 Nut

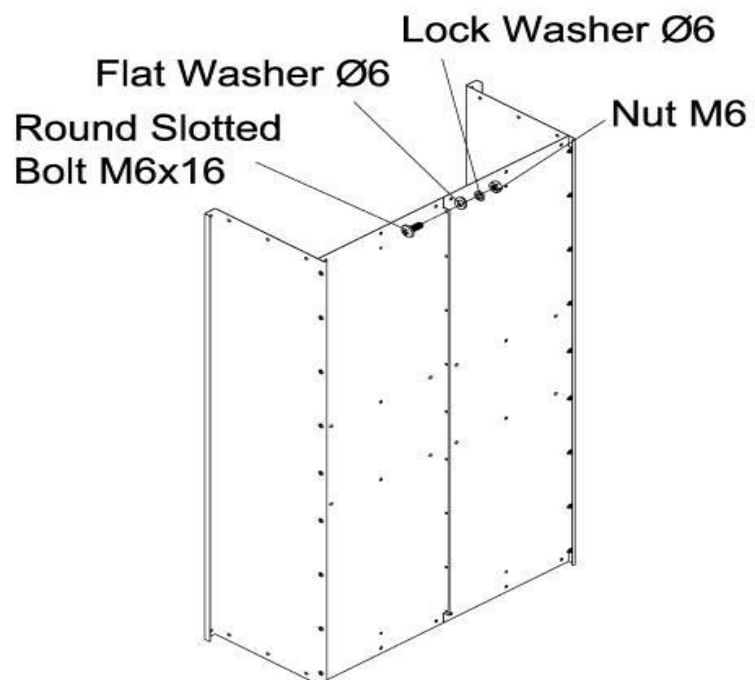

STEP 3: Attach Tailgate Brace and Holding Guides

1. Attach the tailgate brace to the bottom and the sides of the cart box using M8x16 Round Slotted Bolts, Ø8 Flat Washer, Ø8 Lock Washer and M8 Nut. Loosely tighten bolts.
2. Place the tailgate holding guides on the inside of the cart box and attach using M6x16 bolts, Ø6 Flat Washer, Ø6 Lock Washer and M6 nut. Do not tighten.
3. Tighten the bottom and side bolts of the holding guide and brace. Do not tighten the center bolts connecting the bottom panels until the next step.

NOTE: Same bolt are used for both pieces.

Hardware Needed:

- 6 – M8x16 Round Slotted Bolt
- 6 – Ø8 Flat Washer
- 6 – Ø8 Lock Washer
- 6 – M8 Nut
- 6 – M6x16 Round Slotted Bolt
- 6 – Ø6 Flat Washer
- 6 – Ø6 Lock Washer
- 6 – M6 Nut

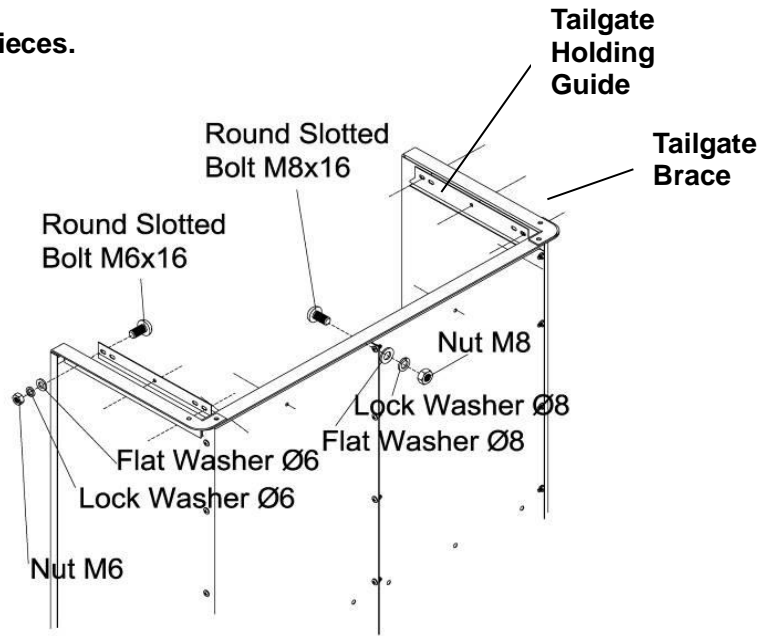

STEP 4: Attach Front Panel

1. Carefully turn the main body completely over so the cart is standing on the tailgate end.
2. Attach the front panel sides using M6x16 Round Slotted Bolts, Ø6 Flat Washers, Ø6 Lock Washers and M6 Nuts. Attach along the bottom of the front panel use M8x16 Round Slotted Bolts, Ø8 Flat Washers, Ø8 Lock Washers and M8 Nuts and tighten.
3. Tighten the center bolts connecting the main panels.

NOTE: Leave holes empty for latch bracket.

Hardware Needed:

- 6 - M6x16 Round Slotted Bolt
- 6 – Ø6 Flat Washer
- 6 – Ø6 Lock Washer
- 6 - M6 Nut
- 4 – M8x16 Round Slotted Bolt
- 4 – Ø8 Flat Washer
- 4 – Ø8 Lock Washer
- 4 – M8 Nut

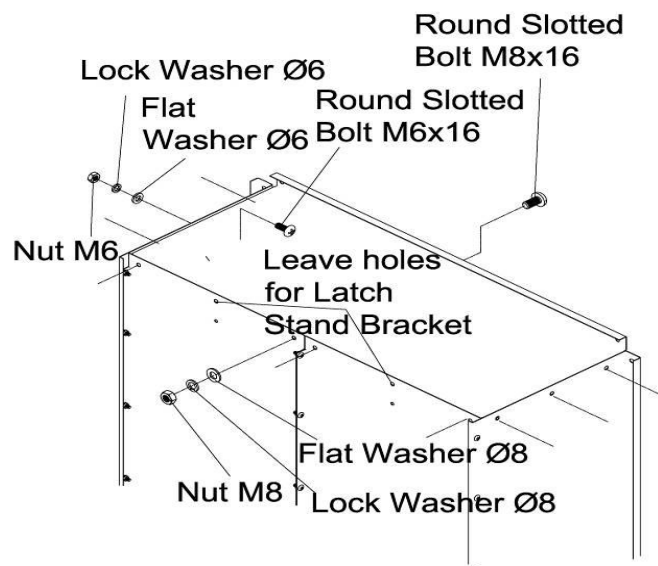

STEP 5: Attach Wheel Support

1. Attach the bottom of the wheel supports to the main body using M8x16 Round Slotted Bolts, Ø8 Flat Washers, Ø8 Lock Washers and M8 Nuts. Fully tighten the bottom bolts.

Hardware Needed:

- 12 – M8x16 Round Slotted Bolt
- 12 – Ø8 Flat Washer
- 12 – Ø8 Lock Washer
- 12 – M8 Nut

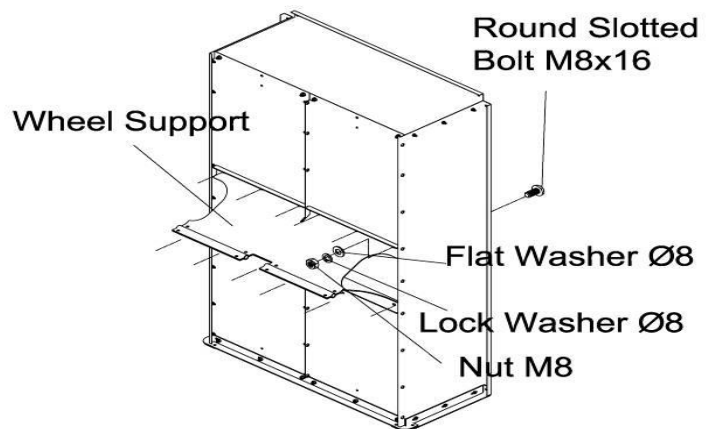

STEP 6: Attach Front Stand Bracket

1. Attach the front stand bracket using M6x16 Round Slotted Bolts, Ø6 Flat Washer, Ø6 Lock Washer and M6 Nut. Fully tighten bolts.

Hardware Needed:

- 4 – M6x16 Round Slotted Bolt
- 4 – Ø6 Flat Washer
- 4 – Ø6 Lock Washer
- 4 – M6 Nut

Note: The hole on Front Stand Bracket should be on right side.

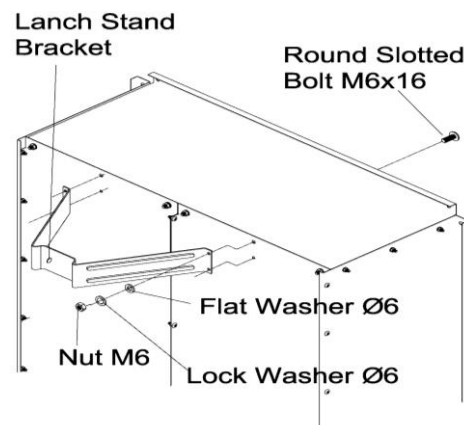

STEP 7: Attach Front and Rear Cap/Brace

1. Attach the front corner caps and rear braces using M6x16 Round Slotted Bolts, Ø6 Flat Washer, Ø6 Lock Washer and M6 Nut. Fully tighten all bolts.

Hardware Needed:

- 6 – M6x16 Round Slotted Bolt
- 6 – Ø6 Flat Washer
- 6 – Ø6 Lock Washer
- 6 – M6 Nut

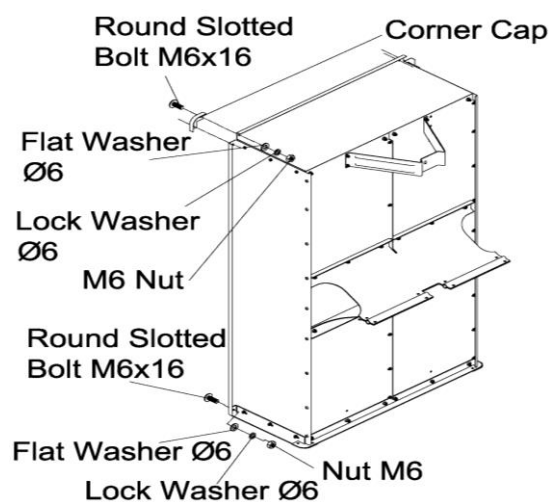

STEP 8: Attach Release Latch

1. Attach release latch to the trailer tongue using M6x20 Hex Bolts, Ø6 Flat Washer, Ø6 Lock Washer and M6 Nut. Fully tighten all bolts.

NOTE: Make sure the release latch is facing the correct direction before installing and DO NOT attach the release latch to the front stand bracket.

Hardware Needed:

- 2 – M6x20 Hex Bolt
- 2 – Ø6 Flat Washer
- 2 – Ø6 Lock Washer
- 2 – M6 Nut

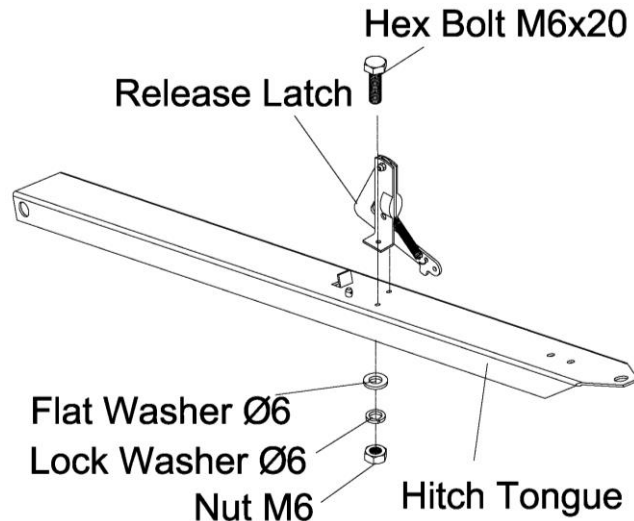

STEP 9: Attach Hitch Bracket

1. Attach hitch bracket to tongue using M8x20 Hex Bolts, Ø8 Flat Washer, Ø8 Lock Washer and M8 Nut.
2. When completed Insert the hitch pin through the hitch bracket and tongue, use the R pin to lock in place.

Hardware Needed:

- 1 – Hitch Bracket
- 2 – M8x20 Hex Bolt
- 2 – Ø8 Flat Washer
- 2 – Ø8 Lock Washer
- 2 – M8 Nut
- 1 – Hitch Pin
- 1 - R Pin

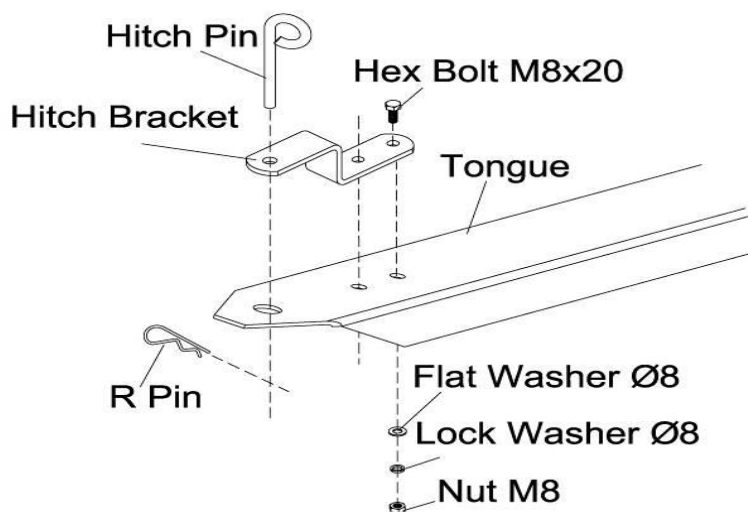

STEP 10: Attach Tongue to Wheel Support

1. Attach tongue by sliding the axle through the wheel support until it reaches the center opening.
2. Align the holes in the tongue with the end of the axle and push the axle through the wheel support.
3. Center the axle and tighten the assembly completely using M8x20 Hex Bolt, Ø8 Flat Washer, Ø8 Lock Washer and M8 Nut.

Note: If the bolts in the upper section of wheel support were installed earlier you may need to loosen the bolts to allow the axle to slide through easily.

Hardware Needed:

- 8 – M8x20 Hex Bolt
- 8 – Ø8 Flat Washer
- 8 – Ø8 Lock Washer
- 8 – M8 Nut

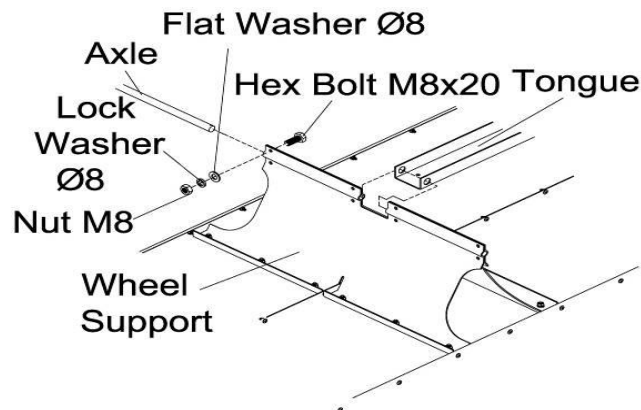

STEP11: Attach Wheel Assembly

1. Slide a Ø20 Flat Washer onto axle and glide the wheel onto the axle
2. Slip another Ø20 Flat Washer and secure using cotter pin.
3. Tap wheel hub cap onto the washer.
4. Repeat the steps for the other wheel.

Note: Axle will fit tightly with wheel, turn wheel while sliding onto the axle.

Hardware Needed:

- 4 – Ø20 Flat Washer
- 2 – Cotter Pin
- 2 – Hub Caps

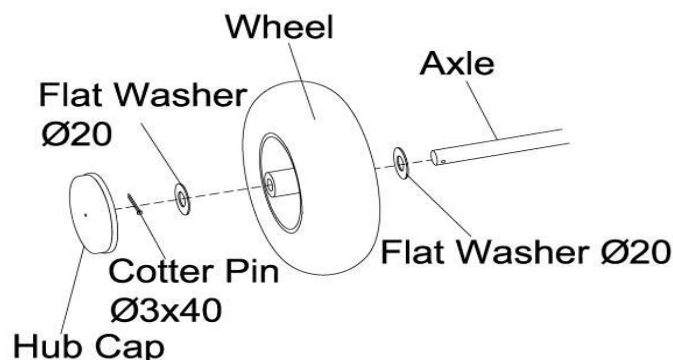

STEP12: Insert Tailgate and Adjust Side Panels

1. Turn the utility dump cart upright onto wheels.
2. Insert the tailgate into the guides and push down.

NOTE: If needed push the back end of side panels in/out by hand so the tailgate slides easily.

STEP13: Attach the R Pin

1. Insert the R Pin into the safety pin on the hitch tongue.
2. Pull out the R Pin before emptying the bed and then press the release handle.

Hardware Needed:

1 - R Pin

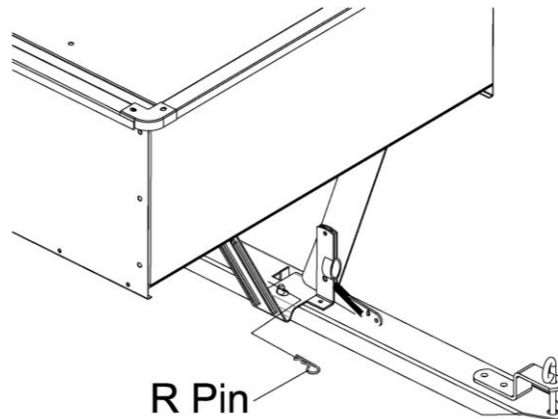

Operation Instructions



WARNING

Before using the utility dump cart, review the instructions below and safety information before operating. Failure to follow these instructions may result in property damage or injury to the operator or bystanders.

USING YOUR UTILITY DUMP CART

1. **DO NOT** exceed rated capacity of 1500lb (680kg)
2. **NEVER** tow the dump cart with box raised.
3. **DO NOT** over fill the utility dump cart. Over flow loads can cause the cart and towing vehicle to lose traction and skid out of control.
4. **ONLY** fill the dump cart to a comfortable dumping load. Extremely heavy loads will be difficult to operate and dump.
5. **ALWAYS** use the dump cart for its intended purpose.
6. **ONLY** use approved vehicles when towing the dump cart (Lawn/Garden Tractors and ATVs)
7. **ALWAYS** make sure that the tow vehicle and the combined weight of the operator **MUST BE** greater than the load of the cart weight for proper control.
8. **DO NOT** use cart on public highways or roads.
9. **NEVER** exceed 10mph when towing the dump cart.
10. **DO NOT** make sharp turns that may cause the Lawn/Garden Tractor or ATV tires to rub against the utility dump cart.
11. **ALWAYS** slow down before turning.
12. **ALWAYS** use caution when backing the utility cart. To avoid the cart from “jack-knifing” always back up in a straight line.

Maintenance and Storage



WARNING

Improper maintenance and storage of the utility dump cart may void your warranty.

MAINTENANCE

- After each use clean material out of the cart box.
- Rinse/dry inside and outside of the dump cart after each use.
- Before operating make sure the tires have the RECOMMENDED TIRE PRESSURE 30 PSI.
- Regularly grease axle and wheel bearing area or when needed.
- Periodically check all fasteners for tightness.
- Annually clean and lightly lubricate parts.
- Use a glossy enamel spray paint to touch up scratched or worn painted metal surfaces.
- Never exceed load capacity rating of 1500lbs it will damage the utility dump cart.

IMPORTANT:

If a part needs replacement, only use parts that meet the manufacturer's specifications. Replacement parts that do not meet specifications may result in a safety hazard or poor operations.

STORAGE

- Never allow material to remain in the utility dump cart for extended periods of time.
- Before storing make sure the cart is clean and dry for years of trouble free service.
- Store indoors or protected area during severe weather and winter months.
- When storing outside always keep the tongue lower to the ground so the cart is not level to allow moisture to easily run off and not stand.

Specifications

Load Capacity	1500lb
Box and Frame Material	Steel
Inside Box Dimensions.....	1480x870x360mm(58 1/4"x34 1/4"x14 3/16")
Overall Dimensions	2075x1035x815mm(81 3/4" x 40 3/4"x32")
Wheel Size.....	16" x 5"
Wheel Type	Pneumatic
Hitch Type	Pin Style
Max. Tire Pressure (PSI).....	30
Unit Weight	65kgs(143.3lb)

IMPORTANT:

The manufacturer reserves the right to make improvements in design and/or changes in specifications at any time without incurring any obligation to install them on units previously sold.

Parts Drawing & Parts List

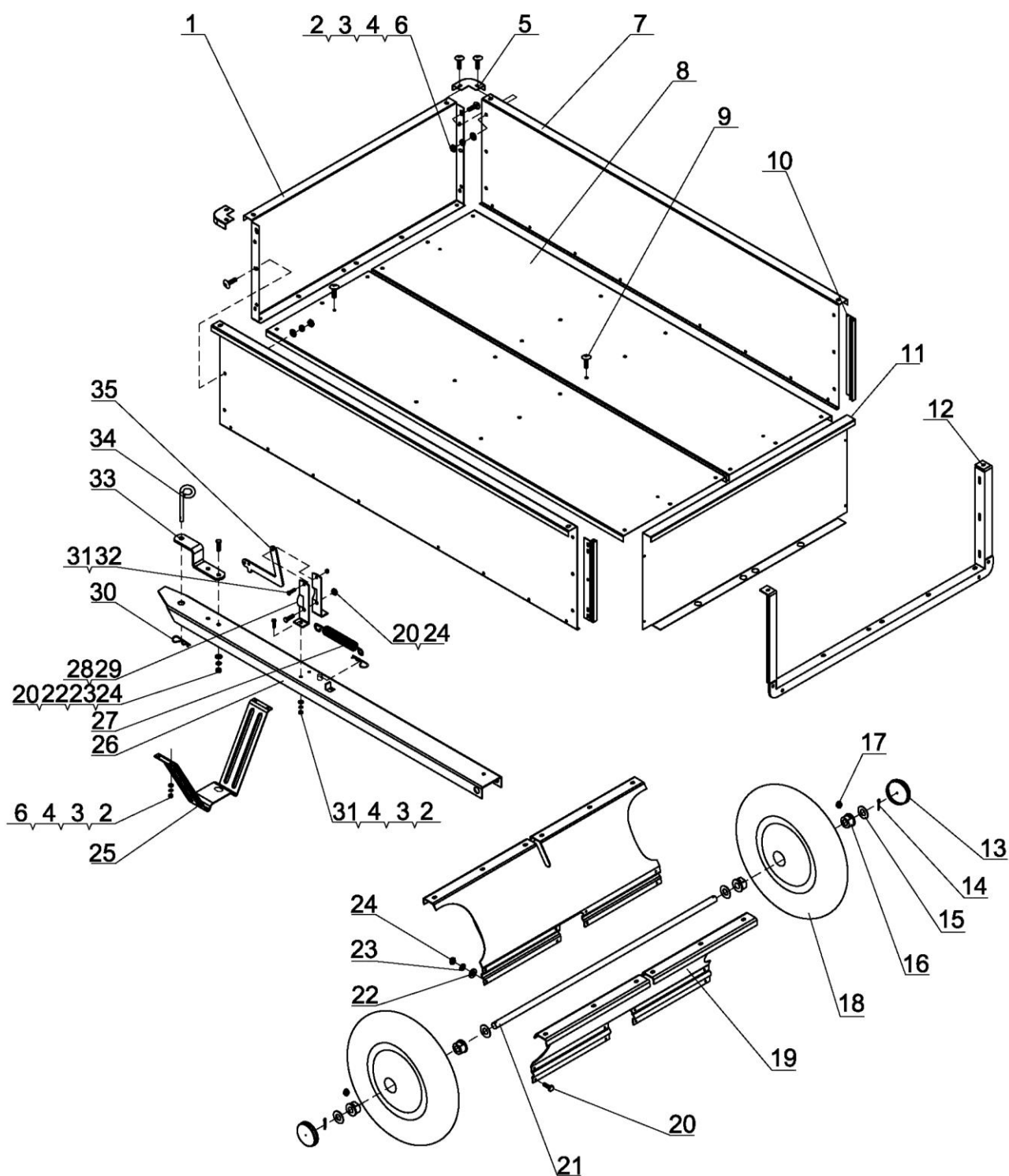

Parts Drawing & Parts List

Ref#	Drawing No.	Description	Qty
1	N180-00001	Front Panel	1
2	9201-06000-DX	Hex Nut M6	51
3	9303-06000-DX	Lock Washer Ø6	51
4	9301-06000-DX	Flat Washer Ø6	51
5	N180-00006	Front Corner Cap	2
6	919901-06016-DX	Round Slotted Screw M6x16	49
7	N180-00002	Side Panel	2
8	N180-00003	Bottom Panel	2
9	919904-08016-DX	Round Slotted Screw M8x16	22
10	N180-00004-DX	Tailgate Holding Guide	2
11	N180-00005	Tailgate	1
12	N180-10000	Tailgate Brace	1
13	N180-00015	Hub Cap	2
14	9404-03040-DX	Cotter Pin Ø3x40	2
15	N180-00012-DX	Flat Washer Ø20	4
16	N180-00016	Axle Bushing	4
17	9701-06000	Grease Cup M6	2
18	N180-20000	Pneumatic Wheel	2
19	N180-00007	Wheel Support	2
20	9101-08020-DX	Hex Bolt M8x20	11
21	N180-00008-DY	Axle	1
22	9301-08000-DX	Flat Washer Ø8	32
23	9303-08000-DX	Lock Washer Ø8	32
24	9201-08000-DX	Hex Nut M8	33
25	N160-00005	Latch Stand Bracket	1
26	N180-03000	Hitch Tongue	1
27	N180-00017-DX	Spring	1
28	N180-00011	Spring Hook Plate (R)	1
29	N180-00018	Spring Hook Plate (L)	1
30	N021-00004-DX	R Pin	2
31	9101-06020-DX	Hex Bolt M6x20	3
32	9206-06000-DX	Nylon Lock Nut M6	1
33	N100-00014	Hitch Bracket	1
34	N180-00013-DX	Lock Pin	1
35	N180-00014	Spring Hook	1