

900KG DUMP CART

Instruction Manual



SAFETY RULES

Remember, any power equipment can cause injury if operated improperly or if the user does not understand how to operate the equipment. Exercise caution at all times when using power equipment.



LOOK FOR THIS SYMBOL TO POINT OUT IMPORTANT SAFETY PRECAUTIONS. IT MEANS—ATTENTION! BECOME ALERT! YOUR SAFETY IS INVOLVED.



CAUTION: VEHICLE BRAKING AND STABILITY MAY BE AFFECTED WITH THE ADDITION OF AN ACCESSORY OR AN ATTACHMENT. BE AWARE OF CHANGING CONDITIONS ON SLOPES.

Exercise caution at all times when using power equipment.

- Read this owners manual before attempting to assemble or operate the cart
- Read the vehicle owners manual and know how to operate your tractor, before using the cart attachment.
- Do not at any time carry passengers in this cart. It has not been designed to carry passengers.
- Never allow children to operate the tractor or the cart attachment.
- Do not allow adults to operate the tractor or cart attachment without proper instructions.
- Always begin with the transmission in first (low) and gradually increase speed as conditions permit.
- Tow the cart at reduced speed over rough terrain and hillsides or near creeks and ditches to prevent tipping over and loss of control. Do not drive too close to a creek or ditch.
- Vehicle braking and stability may be affected with the attachment of this cart. Do not fill cart to maximum weight capacity without checking the capability of the towing vehicle to safely pull and stop with the cart attachment.
- Before operating vehicle on any grade (hill) refer to the safety rules in the vehicle owner's manual concerning safe operation on slopes.
- Do not unhook your cart from the tractor while on a slope. The cart could unexpectedly roll down the slope.
- Do not tow this cart on highways or on public thoroughfares.
- Maximum towing speed is 10 km. p. h.
- Follow maintenance and lubrication instructions as outlined in this manual.

CARTON CONTENTS

- | | | |
|-----------------------------------|---------------------------|--------------------------------|
| 1. Tailgate | 7. Axle, Rear | 13. Tongue, Rear Section |
| 2. Tailgate Reinforcement Bracket | 8. Front Axle Support (2) | 14. Pivot Bars (2) |
| 3. Cart Bed Side Body (2) | 9. Front Axle Channel | 15. Wheels (4) |
| 4. Cart Bed Bottom Body (2) | 10. Tie Rod | 16. Tailgate Guides (2) |
| 5. Front Panel | 11. Hitch Bracket | 17. Tongue Reinforcement Angle |
| 6. Wheel Support (2) | 12. Tongue, Front Section | 18. Corner Caps (2) |

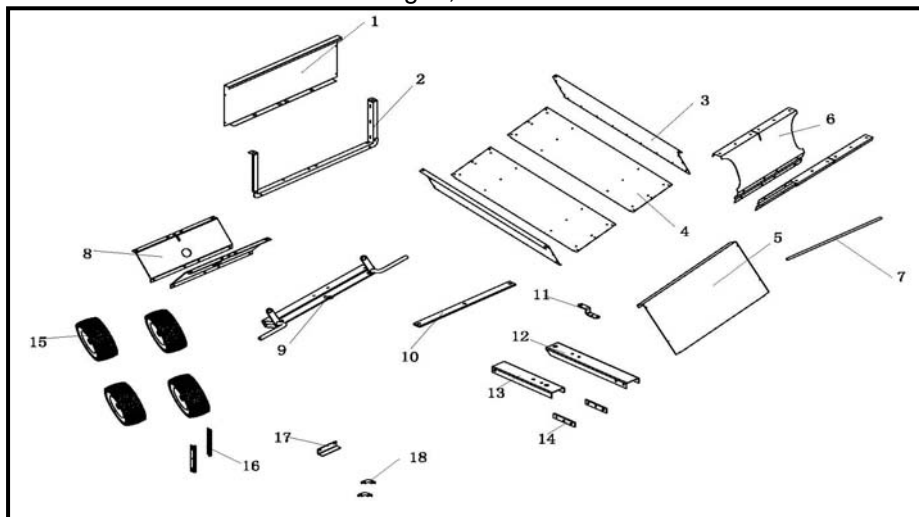

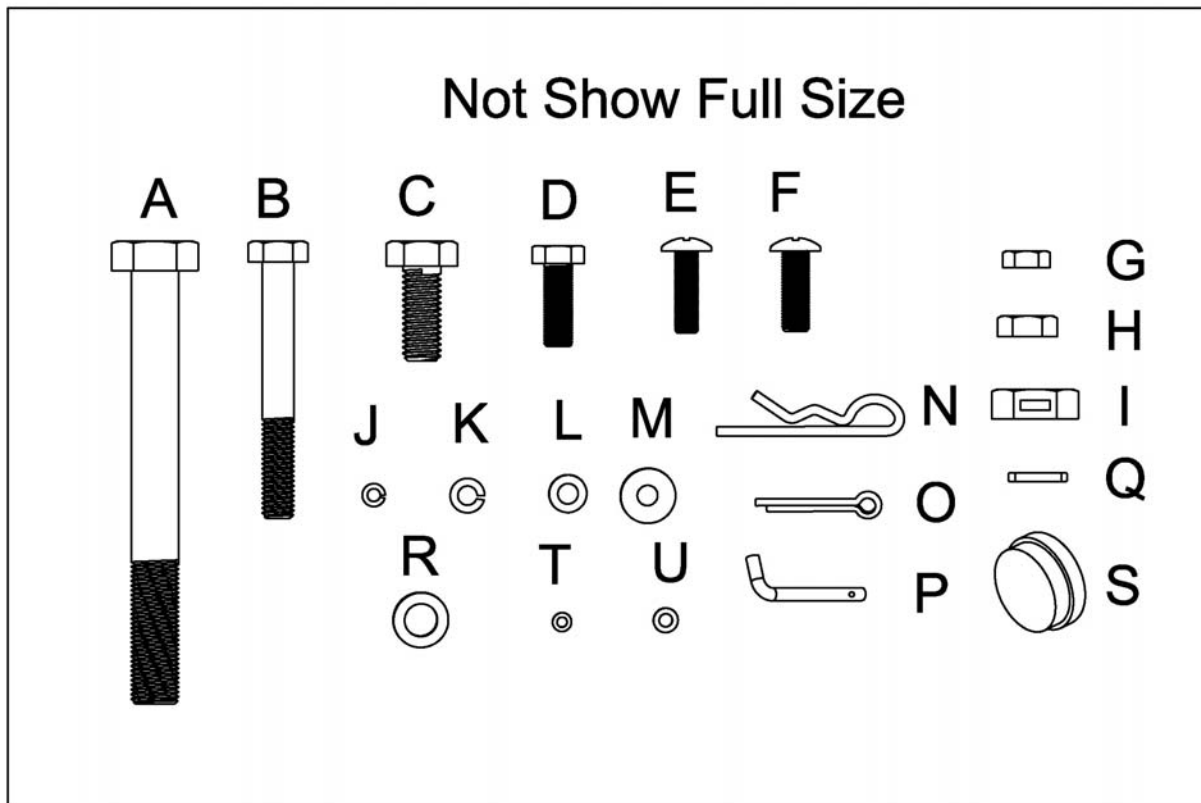

HARDWARE PACK

REF.	QTY.	DESCRIPTION	REF.	QTY.	DESCRIPTION
A	1	Hex Bolt M12X120	L	7	Flat Washer ϕ 12
B	4	Hex Bolt M8X65	M	1	Large Flat Washer ϕ 12
C	3	Hex Bolt M12X30	N	1	Hair Cotter Pin
D	14	Hex Bolt M8X20	O	6	Cotter Pin
E	45	Round Head Bolt M6X16	P	1	Hitch Pin
F	36	Round Head Bolt M8X16	Q	1	Pivot Bushing
G	45	Hex Nut M6	R	8	Flat Washer ϕ 20
H	54	Hex Nut M8	S	4	Hub Cap
I	4	Lock Nut M12	T	45	Flat Washer ϕ 6
J	45	Lock Washer ϕ 6	U	54	Flat Washer ϕ 8
K	54	Lock Washer ϕ 8			

ASSEMBLY INSTRUCTIONS

IMPORTANT: Due to the weight of the cart, we recommend that you have someone assist you in lowering the cart onto its wheels after it has been assembled.



CAUTION

DO NOT LEAVE THE CART UNATTENDED IN UPRIGHT POSITION DURING ASSEMBLY. A FALLING CART CAN CAUSE PERSONAL INJURY. PAY CLOSE ATTENTION TO THE STABILITY OF THE CART WHILE IT REMAINS IN AN UPRIGHT POSITION. FOR BEST STABILITY, ASSEMBLE ON A SMOOTH, LEVEL SURFACE.

1. Remove the hardware pack and all loose parts from the carton. Be sure the carton is empty before discarding.
2. Lay out all the parts and hardware as shown on pages 2 and 3.
3. Assemble the cart bed side body and bottom body with Round Head Bolt M6x16, Flat Washer Ø6, Lock Washer Ø6 and Hex Nut M6. See **Figure 1**.
4. Position cart body halves upright on a smooth level surface such as a garage floor or a paved driveway. See figure 2.
5. Assemble halves together using nine Round Head Bolt M6x16, Flat Washer Ø6, Lock Washer Ø6 and Hex Nut M6 as shown in **Figure 2**.

Do not tighten at this stage.

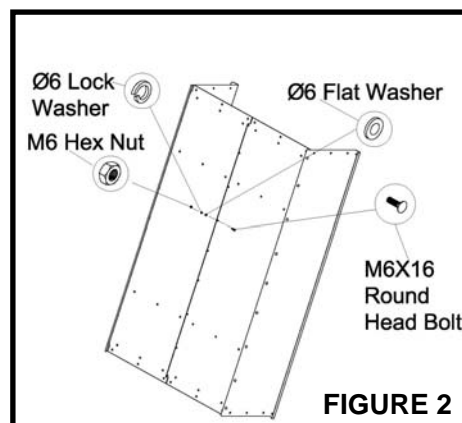
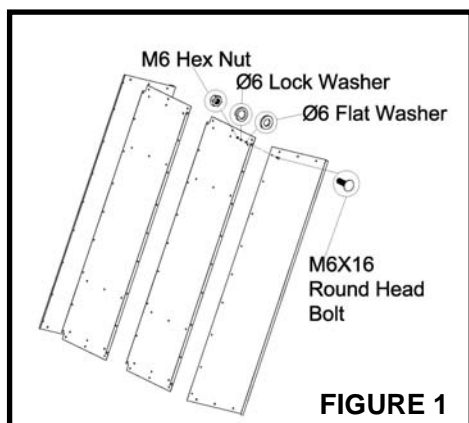

6. Position the tailgate reinforcement bracket on outside of cart as shown in figure 3. Assemble the bottom of the cart body using six Round Head Bolt M8x16, Flat Washer Ø8, Lock Washer Ø8 and Hex Nut M8. Do Not tighten. See **Figure 3**.
7. Position the tailgate guides with the holes to the rear as shown in figure 3. Assemble the guides to the inside of the cart using six Round Head Bolt M6x16, Flat Washer Ø6, Lock Washer Ø6 and Hex Nut M6. Do Not tighten.
8. Assemble two Round Head Bolt M6x16, Flat Washer Ø6, Lock Washer Ø6 and Hex Nut M6 to the top rear corners of the cart. Do Not tighten. See **Figure 3**.
9. Tighten the six bolts assembled in step 6 and the two bolts in step 8. Tighten the nine bolts assembled in step 5, keeping the bottom of the cart body halves even.
10. Lower the cart to rest upside down on its top flanges. See **Figure 4**.
11. Assembling the wheel support at the rear of the cart using twelve M8X16 round head bolts, Flat Washer Ø8, Lock Washer Ø8 and M8 hex nuts as shown in **Figure 4**. Bolt heads go on inside of cart. Tighten.

12. Connecting the 2 wheel supports by eight M8X20 Hex Bolts, Flat Washer Ø8, Lock Washer Ø8 and M8 Nuts.

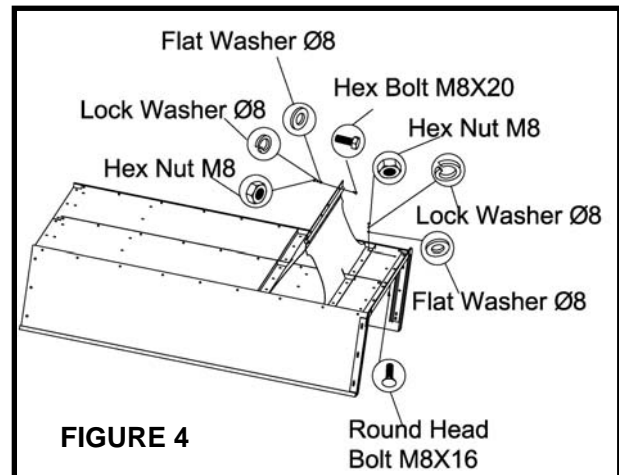
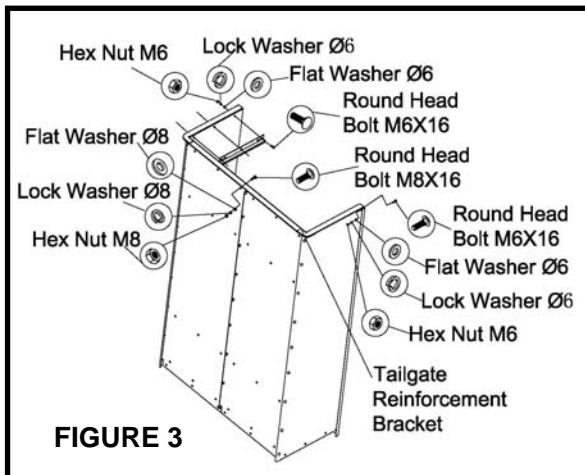

13. Assemble the axle through the wheel support as shown in **Figure 5**.
14. Apply grease to the ends of the axle now or use a grease gun after the wheels are assembled.
15. Assemble a Ø20 flat washer , a wheel (valvestem out) ,another Ø20 flat washer and a cotter pin to each end of the axle as shown in **Figure 5**.
16. Assemble a hub cap over the Ø20 flat washer on each end of the axle as shown in **Figure 5**.
17. Stand the cart on end, front end facing up.
18. Assemble the two front axle supports to the cart using twelve M8X16 round head bolts , Flat Washer Ø8, Lock Washer Ø8 and M8 hex nuts as shown in **Figure 6**. **Do not tighten yet.**

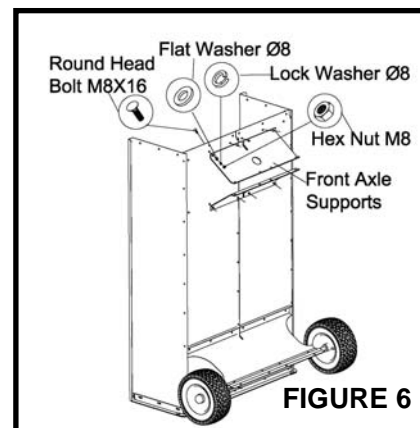
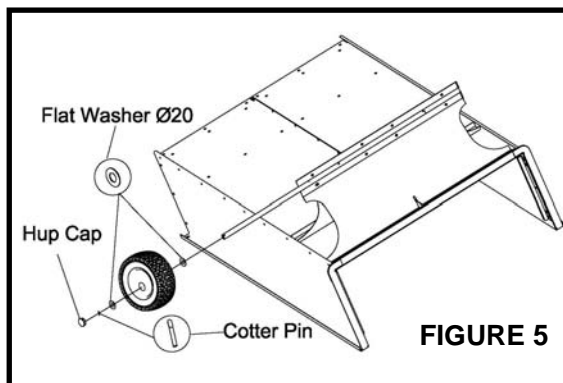

19. Place the front axle channels between the front axle supports. Assemble two M8X65 hex bolts through the holes in the ends of the supports and secure with Ø8 lock washer, Ø8 Flat Washer and M8 hex nuts. Don't tighten. See **Figure 7**.
20. Assemble the tongue reinforcement angle to the back side of the axle supports as shown in Figure 8. Use two M8X65 hex bolts, Ø8 lock washer, Ø8 Flat Washer and M8 hex nuts. Don't tighten.
21. Make sure the center bolt (pivot bolt) is inserted as far as possible through the axle channels and then tighten the four bolts assembled in **Figure 8**, which fasten the front axle supports to the cart bed.
22. Connecting the front panel with the bottom panel by using six M8X16 round head bolts, Ø8 lock washer, Ø8 Flat Washer and M8 hex nuts. Then Connecting the front panel with the side panel by using six M6X16 round head bolts, Ø6 lock washer, Ø6 Flat Washer and M6 hex nuts. See **Figure 9**.

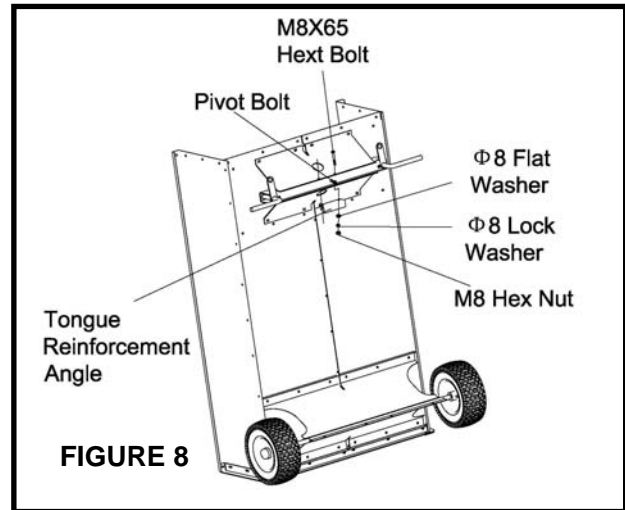
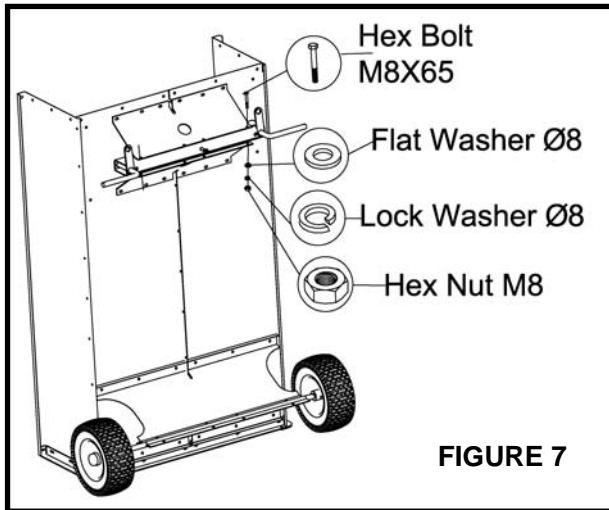

23. Assemble two corner caps to the front of the cart using four M6X16 round head bolts , Ø6 lock washer, Ø6 Flat Washer and M6 hex nuts. Tighten. See **Figure 9**.
24. Assemble the tie rod to the axle spindles using two M12X30 hex bolts, four Ø12 flat washer and two M12 hex lock nuts, Tighten, leaving loose enough that the spindles still pivot. See **Figure 10**.

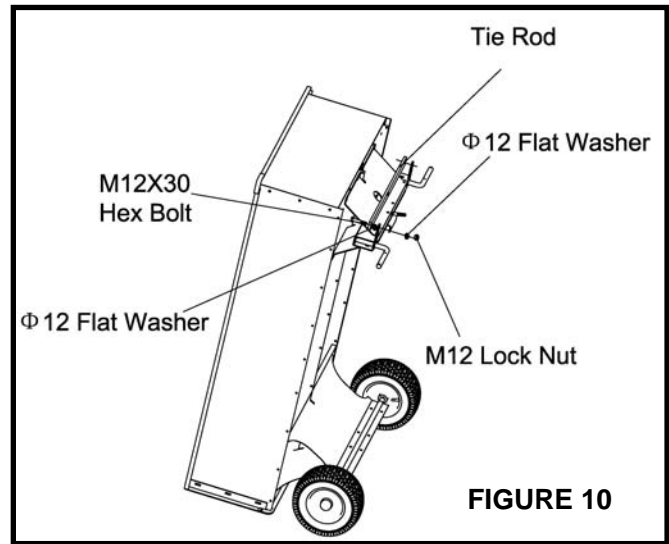
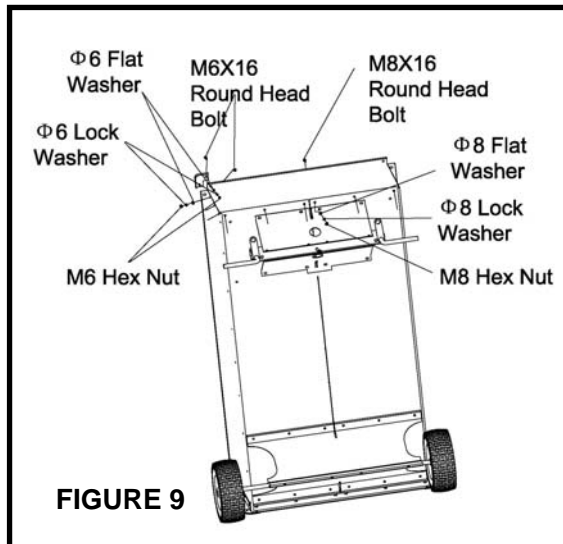

25. Remove the M12 lock nut from the center pivot bolt. Assemble rear tongue section, the pivot bushing, the large Ø12 flat washer and M12 hex lock nut onto the pivot bolts as shown in **Figure 11**. (The pivot bushing fits into the hole in the tongue.) Tighten.
26. Fasten the tongue to the tie rod as shown in Figure 11, using a M12X30 hex bolt, two Ø12 flat washer and a M12 hex lock nut . Tighten, leaving loose enough that the tongue can pivot.
27. Apply grease to the axle spindles now or use a grease gun after wheels are assembled.
28. Assemble a cotter pin to the inside hole in an axle spindle. Place a Ø20 Flat Washer, a wheel (valvstem facing out) and another Ø20 Flat Washer onto the axle spindle. Assemble a cotter pin to the end hole in the axle. Repeat on other side. See **Figure 12**. Note: Prevent the axle spindle from pivoting downward until the wheel is secured to it by the outer cotter pin.
29. Assemble a hub cap over the Ø20 Flat Washer on each wheel. See **Figure 12**.

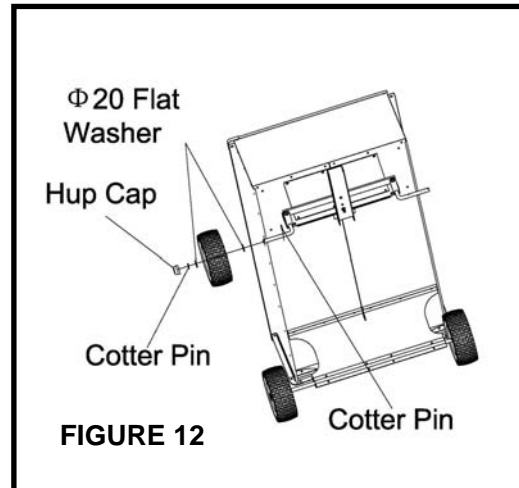
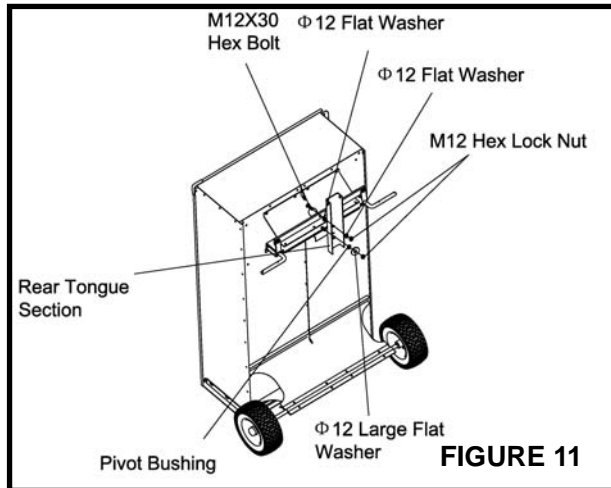

30. To lower the cart onto its wheels you should: a: Ghook the rear wheels as shown in **Figure 13**.b: Get the assistance of another person to help you lower the cart onto it's wheels.
31. Assemble the two pivot bars to the front tongue section using four M8X20 hex bolts, Ø8 lock washer, Ø8 Flat Washer and M8 hex nuts. Don't tighten yet. See **Figure 14**.
32. Assemble the pivot bars to the rear tongue section using a M12X120 hex bolt and Ø12 Flat Washer and M12 hex lock nut. Tighten the lock nut ,leaving it just loose enough to allow the front tongue to pivot. Now tighten the four hex bolts, lock washers and hex nuts assembled to the front tongue in Step 31. See **Figure 14**.

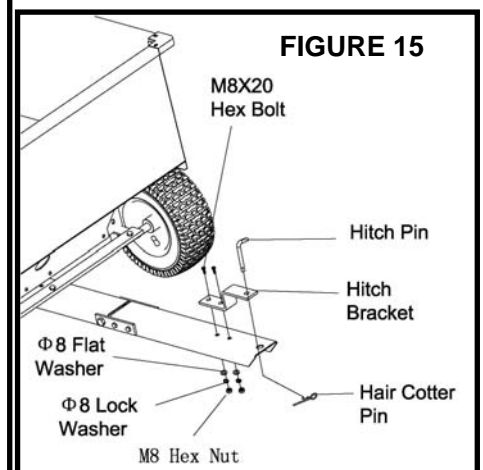
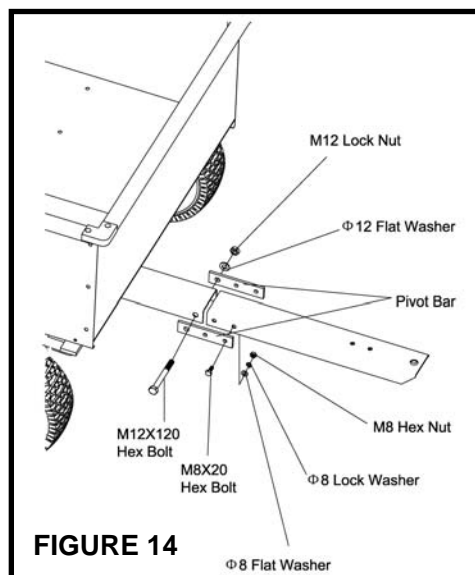
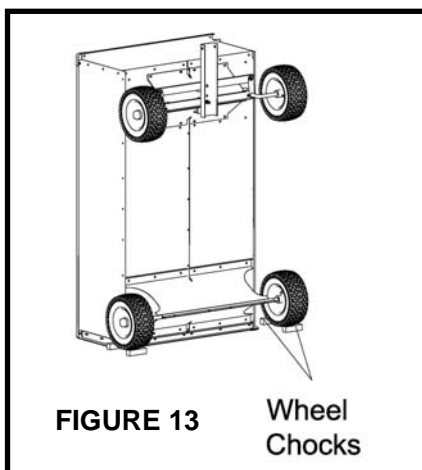

33. Assemble the hitch bracket to the front tongue section using two M8X20 hex bolts, Ø8 lock washer , Ø8 flat washer and M8 hex nuts. Tighten. See **Figure 15**.
34. Assemble the hitch pin through the hitch bracket and the tongue and secure with the hair cotter pin shown in **Figure 15**.
35. Place the tailgate down into the tailgate guides with the top and bottom lips of the tailgate facing to the rear.
36. If you have not yet greased the wheels, fill the wheel hubs with automotive bearing type grease.

OPERATION

CAUTION: VEHICLE BRAKING AND STABILITY MAY BE AFFECTED WITH THE ADDITION OF AN ACCESSORY OR AN ATTACHMENT. BE AWARE OF CHANGING CONDITIONS ON SLOPS.

1. Refer to the vehicle owners manual for instruction on safe operation on slopes.
2. For best handling and traction, distribute the weight of the load evenly in the cart.
3. Always test to make sure your tractor has adequate towing and braking capabilities whenever hauling a substantial amount of weight in your cart. Use extra caution when operating on slopes.

NOTE

DO NOT EXCEED WEIGHT CAPACITY OF CART.(See the specification on the page.)

4. Do not unhook your cart from the tractor while on a slope. The cart could unexpectedly roll down the slope.
5. Backing up with a 4 wheel steerable cart takes practice! Before using the cart for hauling, practice braking the empty cart in a level, open area.
6. To empty material from the cart, remove the tailgate by lifting it straight up and out from between the guides. Material can then be raked or pulled out from the rear of the cart.
7. The maximum towing speed for this cart is 10km.p.h.

MAINTENANCE

1. At the beginning of each season, lubricate, with a light machine oil, all bolt that are pivot points, lubricate, with a light split plastic bearings for the front axle spindles.
2. Grease or oil the wheel bearings periodically. Use automotive wheel bearing type grease of 20 weight oil.
3. Keep tires filled to the recommended tire pressure of 30PSI.