

5

ROTARY TILLER OPERATOR MANUAL

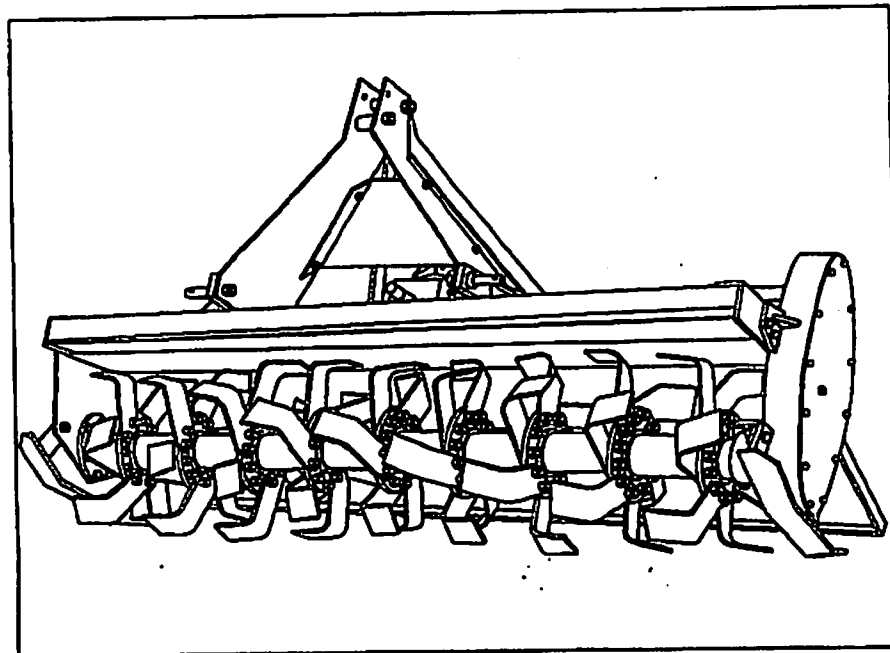

It is the purchaser and/or operator's responsibility to....

- **Read and understand the information contained in this manual.**
- **Operate, lubricate, assemble and maintain the equipment in accordance with all instructions and safety procedures in this manual.**
- **Inspect the equipment and replace or repair any parts that are damaged or worn which under continued operation would cause damage, wear to other parts, or cause a safety hazard.**
- **The warnings, cautions and instructions discussed in this instruction manual cannot cover all possible conditions and situations that may occur.**

- **It must be understood by the operator that common sense and caution are factors which cannot be built into this product, but must be supplied by the operator.**

CONTENTS

ITEM	PAGE
Safety	3
Safety Sign Locations	6
Assembly Instructions	10
Preparation	13
Operating Instructions.....	16
Maintenance.....	17
Parts Diagram	19

SAFETY

READ AND FOLLOW THE INSTRUCTIONS IN THIS MANUAL AND ESPECIALLY IN THE SAFETY SECTION. FAILURE TO DO SO CAN RESULT IN SERIOUS INJURY OR DEATH.

TAKE NOTE! THIS SAFETY ALERT SYMBOL FOUND THROUGHOUT THIS MANUAL IS USED TO CALL YOUR ATTENTION TO INSTRUCTIONS INVOLVING YOUR PERSONAL SAFETY AND THE SAFETY OF OTHERS.

SIGNAL WORDS:

The signal words **DANGER**, **WARNING** and **CAUTION** are used with the safety messages in this manual and with each safety sign. They are defined as follows:

DANGER: Indicates an immediate hazardous situation that, if not avoided, could result in serious injury or death. This signal word is to be limited to the most extreme situations typically for machine components that, for functional purposes, cannot be guarded.

WARNING: Indicates a potentially hazardous situation that, if not avoided, could result in serious injury or death, and includes hazards that are exposed when guards are removed. It may also be used to alert against unsafe practices.

CAUTION: Indicates a potentially hazardous situation that, if not avoided, may result in minor or moderate injury. It may also be used to alert against unsafe practice.



**THIS SYMBOL MEANS
ATTENTION!
BECOME ALERT!
YOUR SAFETY IS INVOLVED**

EQUIPMENT SAFETY GUIDELINES



- **Safety of the operator and by standards is one of the main concerns in designing and developing a mower. However, every year accidents occur which could have been avoided by a few seconds of thought and a more careful approach to handling equipment. You, the operator, can avoid many accidents by observing the following precautions and insist those working with you, or for you, follow them.**
- **In order to provide a better view, certain photographs or illustrations in this manual may show an assembly with a safety shield removed. However, equipment should never be operated in this condition. Keep all shields in place. If shield removal becomes necessary for repairs, replace the shield prior to use.**
- **Replace any safety sign that is not readable or is missing. Location of such safety signs is indicated in this manual.**
- **Never use alcoholic beverages or drugs that can hinder alertness or coordination while operating this equipment. Consult your doctor about operating this machine while taking prescription medications.**
- **Under no circumstances should children under the age of 18 be allowed to work with this equipment. Do not allow persons to operate or assemble this unit until they have read this manual and have developed a thorough understanding of the safety precautions and of how it works. Review the safety instructions with all users annually.**
- **This equipment is dangerous to children and persons unfamiliar with its operation. The operator should be a responsible, properly trained and physically able person familiar with farm machinery and trained in this equipment's operations. If the elderly are assisting with farm work, their physical limitations need to be recognized and accommodated.**
- **Use a tractor equipped with a Roll Over Protective System and seat belts. (ROPS)**
- **Never exceed the limits of a piece of machinery. If its ability to do a job, or to do so safely, is in question- DON'T TRY IT.**
- **Do not modify the equipment in any way. Unauthorized modification could result in serious injury or death and may impair the function and life of the equipment.**
- **In addition to the design and the confirmation of this implement, including safety signs and safety equipment, hazard control and accident prevention are dependent upon the awareness, concern, prudence, and proper training of personnel involved in the operation, transport, maintenance, and storage of the machine. Refer also to safety messages and operation instruction in each of the appropriate sections of the tractor and tiller manuals. Pay close attention to the safety signs affixed to the tractor and the rotary tiller.**

STARTING AND STOPPING SAFETY



- Pass rotary tiller diagonally through sharp dips and avoid sharp drops to prevent "hanging up" tractor and rotary mower. Practice will improve your skills in maneuvering on rough terrain. Always cut down slopes, never across the face. Always check tractor manual for proper use on slopes.
- When using a unit, a minimum 20% of tractor and equipment weight must be on tractor front wheels. Without this weight, the tractor could tip over, causing personal injury or death. The weight may be attained with a front-end loader, front wheel weights, ballast in the tires or front tractor weights. When attaining a minimum 20% of tractor and equipment weight on the front wheels, you must not exceed the ROPS weight certification. Weigh the tractor and equipment. Do not guess or estimate!

TRANSPORT SAFETY



- Comply with state and local laws governing highway safety and movement of farm machinery on public roads.
- The use of flashing amber lights is acceptable in most localities. However, some localities prohibit their use. Local laws should be checked for all lighting and marking requirements.
- At all times, when driving the tractor and equipment on the road or highway under 20mph (32kph) use flashing amber warning lights and a slow moving vehicle (SMV) identification emblem. Do not exceed 20 mph (32 kph). Reduce speed on rough roads and surfaces.
- Plan your route to avoid heavy traffic.
- Always install transport locks, pins or brackets before transporting.
- Do not drink and drive.
- Be a safe and courteous driver. Always yield to oncoming traffic in all situations, including narrow bridges, intersections, etc. Watch for traffic when operating near or crossing roadways.
- Turn curves or go up or down hills only at a low speed and at a gradual steering angle. Make certain that a least 20% of the tractor's weight is on the front wheels to maintain safe steering. Slow down on rough or uneven surface. Always check tractor manual for proper use on slopes.
- Use extreme care and maintain minimum ground and when operating close to ditches or fences. Be careful when turning sharp corners.
- Never allow riders on either tractor or tiller.

SAFETY SIGN LOCATIONS

The types of safety signs and locations on the equipment are shown in the illustration below. Good safety requires that you familiarize yourself with the various safety signs, the type of warning and the area, or particular function related to that area, that requires your **SAFETY AWARENESS**.

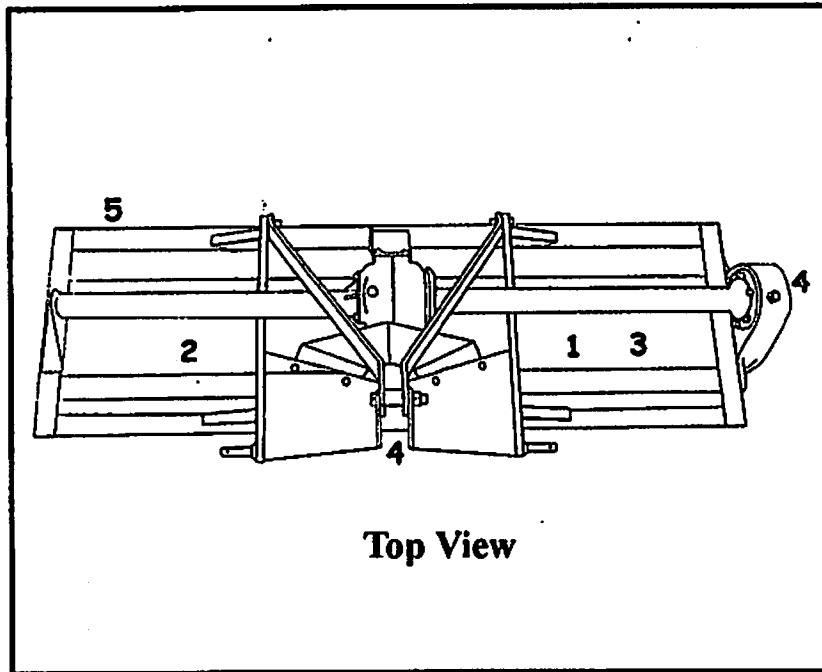

Top View

Note: The numbers represent the safety decals on the following pages.

REMEMBER: If safety signs have been damaged, removed, become illegible or parts have been replaced without signs, new safety signs must be applied. New safety signs are available from your authorized dealer, distributor or factory.

To prevent serious injury or death:
*si no lee ingles, pida ayuda a alguien que si lo lee para
que le traduzca las medidas de seguridad*

- Read and understand Operator's Manual before using.
Review annually.
- Do not permit riders on the tractor or tiller, including children
- Do not allow children to operate tiller.
- Operate only with guards installed and in good working condition
- Keep away from moving parts
- Operate only with tractor equipped with ROPS and seatbelts.
- Use extra care when operating on rough terrain or when rocks or debris are present.
- Do not operate in the raised position.
- Stop engine, lower tiller, set brake and wait for all moving parts to stop before dismounting.
- Support tiller securely before working beneath it.
- Transport with clean reflectors, SMV and working lights as required by federal, State, and local laws.
- Keep yourself, others, and clothing away from the rotating PTO
- Operate only at a safe distance from bystanders
- Do not stand between tractor and tiller.
- Be careful on uneven terrain. Decrease speed when turning.
- Locate underground utility lines before tilling.
- Do not exceed a safe transport speed.

⚠ DANGER



**ROTATING DRIVELINE HAZARD
KEEP AWAY**

To prevent serious injury or death from rotating driveline:

- Keep all guards in place when operating.
- Operate only at 540 RPM
- Keep hands, feet, clothing and hair away from moving parts.
- Do not operate without driveline securely attached at both ends.
- Do not operate without driveline shields that turn freely on driveline.

2

⚠ WARNING



TO PREVENT SERIOUS INJURY OR DEATH

- Keep hands and body out of hitch area when attaching mower to tractor.
- Keep body clear of crush point between tractor and mower.

3

8

**SHIPPED WITHOUT OIL IN GEAR BOX
AND WITHOUT GREASE IN GREASE FITTINGS.
"CONSULT OWNERS MANUAL FOR
LUBRICATING AND OPERATING INSTRUCTIONS."**

4



5

9

ROTARY TILLER ASSEMBLY INSTRUCTIONS

STEP 1

With rotary tiller still in crate, lay flat on a level surface. Cut banding straps on the two (2) upright crate posts.

STEP 2

Remove the top & upper side sections of the crate, leaving the rotary tiller resting on the bottom section.

STEP 3

Remove tie wire holding the PTO shaft and set aside PTO.

STEP 4

Attach tiller according to your tractor's manual and using the instructions on pages 15 and 16.

STEP 5

Install tail back plate chain.

STEP 6

Install PTO shaft.

Note: The safety chains on the PTO shaft should be attached to the tractor and tiller to prevent the plastic safety shield from rotating.

BEFORE PUTTING ROTARY TILLER INTO SERVICE

(IMPORTANT-INSTRUCTIONS PRIOR TO START UP)
SHIPPED WITHOUT OIL IN GEAR BOXES AND WITHOUT GREASE IN
GREASE FITTINGS. UNIT MUST BE SERVICED BEFORE USING

- Fill Gearbox using gear oil (type GL5-85W 140 or Triple Zero Grease; which can be poured, and has "EP" i.e. "Extreme Pressure" additives.)
- For all Grease Fittings use TYPE/grade II tube grease.

STEP 1 Place rotary tiller so that the deck is secure and level.

STEP 2 Remove 1/2" Pipe Plug (Located at top of transmission gearbox). See Figure A.

STEP 3 Fill gearbox using gear oil until gearbox is approximately 1/2 full. See Figures B.

STEP 4 Replace and tighten the 1/2" pipe plug and clean away any excess oil. See Figure C.

STEP 5 Remove 1/2" Pipe Plug (Located at top of side gearbox, See Figure D) and the 1/8" check plug (Located in side of the side gearbox).

STEP 6 Fill side gearbox using gear oil until the oil begins to overflow from the checkplug hole. See Figure E.

STEP 7 Replace and tighten the 1/2" vent plug and the 1/8" check plug. Clean away any excess oil. See Figure F.

STEP 8 Grease the grease fitting on the "out-board hub," the two (2) grease fittings on the PTO universal joints, the two (2) grease fittings on the PTO safety shield and the inner surface portion of the PTO shaft. See Figures G,H and I.

CAUTION:

DO NOT over fill gearbox. This could cause damage to oil seals and can cause permanent damage to the gearbox. This issue will not be covered under warranty.



Figure A



Figure B



Figure C

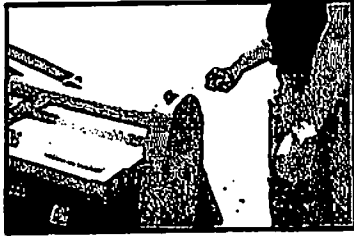

Figure D

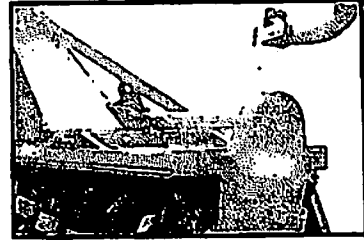

Figure E

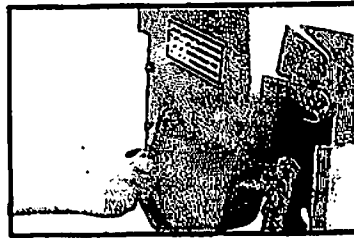

Figure F

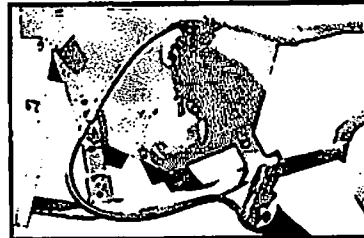

Figure G



Figure H

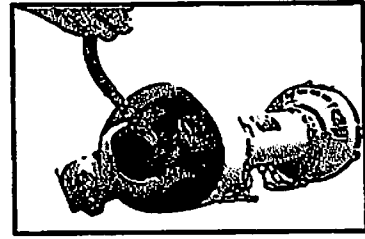

Figure I

PREPARATION



- Never operate the tractor and tiller until you have read and completely understand this manual, the Tractor Operator's Manual, and each of the safety messages found on the safety signs on the tractor and tiller.
- Personal protection equipment including hardhat, safety glasses, safety shoes, and gloves are recommended during assembly, installation, operation, adjustment, maintenance, repairing, removal, or moving the implement. Do not allow long hair, loose fitting clothing, or jewelry to be around equipment.
- **PROLONGED EXPOSURE TO LOUD NOISE MAY CAUSE PERMANENT HEARING LOSS!** Tractors with or without tillers attached can often be noisy enough to cause permanent, partial hearing loss. We recommend that you wear hearing protection on a full-time basis if the noise in the operator's position exceeds 80 db. Noise over 80 db on a long-term basis can cause severe hearing loss. Noise over 90 db adjacent to the operator over a long-term basis may cause permanent, total hearing loss. **NOTE:** Hearing loss from loud noise (from tractors, chain saws, radios, and other such sources close to the ear) is cumulative over a lifetime without hope of natural recovery.
- Operate the tiller only with a tractor equipped with an approved Roll-Over-Protective System (ROPS). Always wear your seat belt. Serious injury or even death could result from falling off the tractor — particularly during a turnover when the operator could be pinned under the ROPS or the tractor.
- Clear area to be tilled of stones, branches or other debris that might be thrown or entangled in the tiller, causing injury or damage.
- Operate only in daylight or good artificial light.
- Ensure tiller is properly mounted, adjusted and in good operating condition.
- Ensure that all safety shielding and safety signs are properly installed and in good condition.

STARTING AND STOPPING SAFETY



- Check the tractor master shield over the PTO stub shaft. Make sure it is in good condition and fastened securely to the tractor. Purchase a new shield if old shield is damaged or missing.
- All tractors that are not equipped with a "live" power takeoff (PTO) need to be equipped with an over-running PTO clutch. These are available through most farm equipment stores. **NOTE:** The addition of an over-running PTO clutch may change the length of the PTO driveline required. Pay extra attention to the instructions on the PTO Driveline Installation. Be sure that the driveline system guarding is adequate.
- Tiller operating power is supplied from the tractor PTO. Refer to your tractor manual for PTO engagement and disengagement instructions. Know how to stop tractor and tiller quickly in case of an emergency.
- When engaging PTO, the engine RPM should always be at idle speed. Once engaged and ready to start tilling, raise PTO speed to 540-RPM and maintain throughout tilling operation.

ATTACHING TO TRACTOR

⚠ WARNING ⚠
Never stand between
tractor and rotary tiller
while backing up tractor
to the hitch.

STEP 1

Attach to tractor's category 1 three point hitch as described in the Tractor's Operator's Manual.

STEP 2

Determine if the PTO shaft needs to be shortened.

NOTE:

Due to the many variations in the tractor hitch points and distances between equipment gearbox input shaft and tractor PTO output shafts, some combinations may require PTO shafts to be shortened as described by the following steps.

STEP 3

Raise and lower rotary tiller in order to locate the shortest distance between equipment gearbox input shaft and tractor PTO output shaft. With the rotary tiller in the shortest distance position shut down the tractor and **SECURELY BLOCK ROTARY TILLER IN POSITION.**

STEP 4

Pull apart PTO shaft and attach outer section to tractor PTO output shaft. **NOTE:** Be sure to pull on PTO shaft section to ensure yoke has locked into place.

STEP 5

Place and hold inner PTO shaft section next to outer section and check if PTO shaft is too long. Each section should end approximately 3 inches short of reaching u-joint shield on the opposite section. If the shaft is too long measure 3 inches back from each u-joint shield and mark the other shaft section. Be sure to do this for both PTO shaft halves. **NOTE:** Do not cut PTO shaft sections at this time.

ATTACHING TO TRACTOR *continued...*

STEP 6

Raise rotary tiller and remove blocking. Raise and lower rotary tiller in order to locate the longest distance between equipment input shaft and the tractor PTO output shaft. With the rotary tiller in the longest distance position shut down the tractor and **SECURELY BLOCK THE ROTARY TILLER IN POSITION.**

STEP 7

As in step 5 hold PTO shaft sections together and check for a minimum of 6 inches of overlap. If PTO shaft has been marked for cutting the overlap is the distance measured between the two marks. If the PTO shaft has less than a 6 inch overlap, **DO NOT USE.** Contact your authorized Dealer.

STEP 8

Apply any multi-purpose grease to the outside of the male (Inner) PTO shaft section. Assemble PTO shaft and install on rotary tiller and tractor.

STEP 9

Pull on tractor side of PTO shaft yoke to be sure it has locked in place. Make certain PTO shaft shielding is in place and good working condition.

STEP 10

The PTO shaft shield is a non-rotating design and must be secured prior to equipment use. Using the chain on each yoke shield attach to a fixed object on the tractor and equipment ends that will not allow the PTO shaft shield to rotate during operation.

OPERATING INSTRUCTIONS

STEP 1

Before each use perform the maintenance described in maintenance section (page 18).

STEP 2

Read, understand, and follow the information on safety training, preparation, starting and stopping safely, operational safety, transport safety warning sections of this manual.

STEP 3

With the rotary tiller positioned on level ground, adjust the tractor lift arms so that when lifted, the rotor bar remains parallel to the ground.

STEP 4

With the rotary tiller attached to the tractor, raise and support the tiller with suitable blocks. Adjust the skids, located on the sides of the tiller. The adjustment bolts for both right and left sides should be positioned in the same adjustment hole. This allows the tiller to till the same depth on each side. Adjust the back plate, with regulating chain, until the desired mulching effect is found. **Note: Never attempt to adjust the rotary tiller while the tractor is running.**

STEP 5

Raise the tiller and remove the blocks. Lower the tiller to the ground.

STEP 6

With the tractor at idle RPM and the tiller lifted off of the ground, engage PTO and slowly advance throttle to 540 PTO RPM. **NOTE: Rotary tiller is designed to run at 540 PTO RPM only.**

STEP 7

Select a low gear for the tractor and begin to move forward. Tractor ground speed is to be controlled by gear selection only and not engine speed. As the tractor moves forward, slowly lower the tiller down. Allow the tiller tines to gradually engage the ground.

NOTE: Do not allow the tractor engine or rotary tiller to bog down or stall. This causes undue wear and tear on the tiller and tractor. If this continues to happen reduce ground speed and raise tilling depth of rotary tiller. Never attempt to remove objects from the rotor bar until the tractor has been shut down and the tiller tines have completely stopped.



WARNING



Never travel at a fast ground speed while using the tiller, this could damage it. Never attempt to turn the tractor or travel in reverse with the PTO engaged and the tiller in the ground. Always raise the tiller out of the ground when backing up or attempting to turn. Failure to do so may cause damage to the tiller.

STEP 8

After each use clean all debris from the tiller tines. Replace any missing or illegible safety decals. Inspect for any damaged or worn parts and replace before next use. Store rotary tiller in a dry environment.

MAINTENANCE



- 1). Periodically check and maintain proper gear oil level.
- 2). Every 8 hours, (1) grease "out-board hub", (2) PTO shaft universal joints, (3) PTO shaft safety shield and (4) PTO telescoping surface.

NOTE: Use only a grade Type II tube grease.

NOTE: Do not grease the slip clutch assembly.

- 3). Before each use check to make sure all safety shields are installed and working properly.
 - 4). Check tiller tines for cracks and breaks before every use.
 - 5). Periodically check all nuts and bolts to insure they are tight and secure.
 - 6). Periodically loosen torque spring bolts and allow slip clutch to slip for approximately two (2) revolutions. Loosen the bolts until the springs lose contact with the flange yoke. This ensures that the slip clutch is not in a "locked" position.
 - 7). Make sure that the clutch slips.
 - 8). To retighten the slip clutch, tighten the torque spring bolts until the nut makes contact with the flange yoke and further tighten one and a half turns (1-1/2). This is a good starting point, further adjustments may need to be made based on soil conditions.
- NOTE:** Do not over or under tighten slip clutch assembly or damage may occur.

MAINTENANCE SAFETY



- Good maintenance is your responsibility. Poor maintenance is an invitation to trouble.
 - Follow good shop practices.
 - Keep service area clean and dry

- Be sure electrical outlets and tools are properly grounded
 - Use adequate light for the job at hand.
-
- Make sure there is plenty ventilation. Never operate the engine of the towing vehicle in a closed building. The exhaust fumes may cause asphyxiation.
 - Before working on this machine, disengage the PTO, shut off the engine, set the brakes, and remove the ignition keys.
 - Be certain all moving parts on attachments have come to a complete stop before attempting to perform maintenance.
 - Never work under equipment unless it is blocked securely.
 - Always use personal protection devices such as eye, hand and hearing protectors, when performing any service or maintenance.
 - Frequently check tiller lines. They should be sharp, free of nicks and cracks and securely fastened.
 - Periodically tighten all bolts, nuts, and screws and check that all cotter pins are properly installed to ensure unit is in safe condition.
 - When completing a maintenance or service function, make sure all safety shields and devices are installed before placing unit in service.
 - After servicing, be sure all tools, parts and service equipment are removed from tiller.
 - Do not allow debris, grease or oil to build up on any deck or platform.
 - Where replacement parts are necessary for periodic maintenance and servicing, genuine factory replacement parts must be used to restore your equipment to original specifications.
 - The manufacturer will not be responsible for injuries or damages caused by use of unapproved parts and/or accessories.
 - A fire extinguisher and the first aid kit should be kept readily accessible while performing maintenance on this equipment.

STORAGE SAFETY

- Following operation, or when unhooking the tiller, stop the tractor, set the brakes, disengage the PTO, shut off the engine and remove the ignition keys.
- Store the unit in an area away from human activity.
- Do not park equipment where it can be exposed to direct contact to livestock for long periods of time. Damage and livestock injury could result.
- Make sure all parked machines are on a hard, level surface and engage all safety devices.

TILLER PARTS DIAGRAM

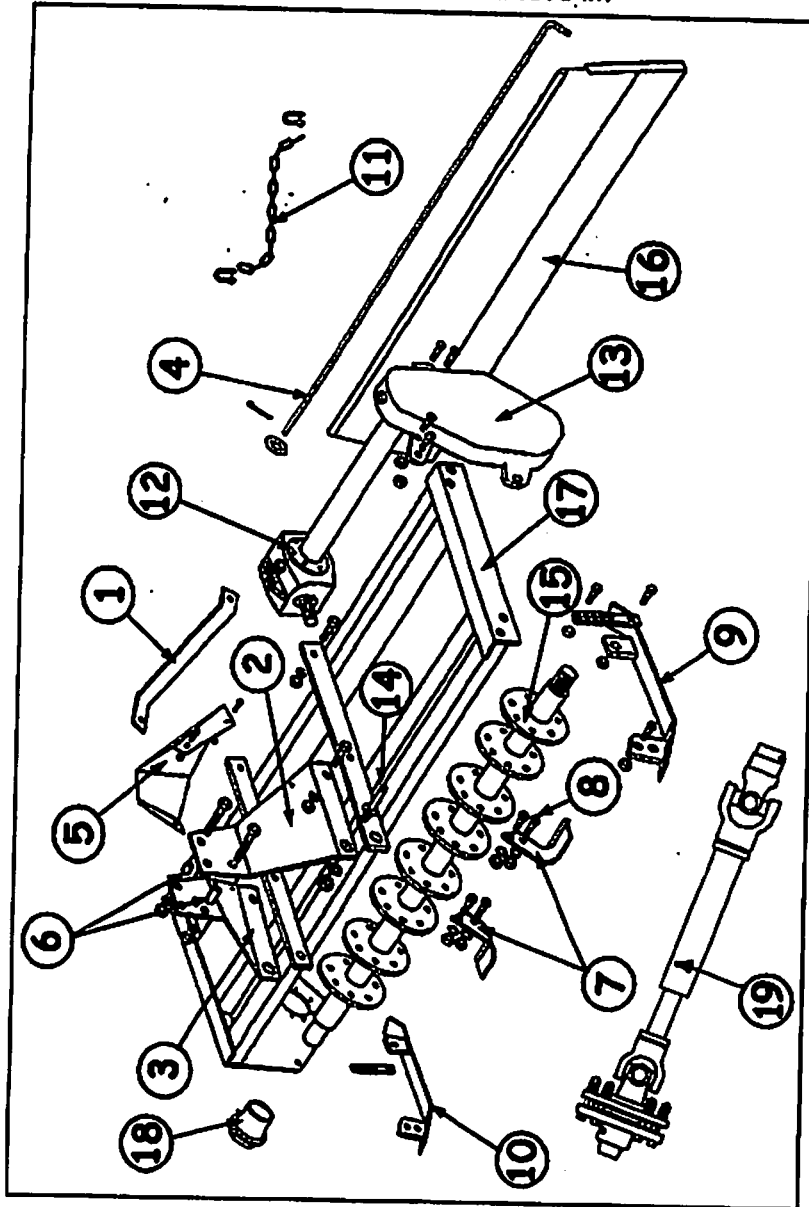

Ref. No.	Part Name
1	Lift Arm Brace
2	Lift Arm (left hand)
3	Lift Arm (right hand)
4	Tail Rod Assembly
5	Center Piece Kit
6	Lift Arm Spacer Kit
7	Tine Pkg. (1 right & 1 left) w/ bolts
7	Tine Pkg. (3 right & 3 left) w/bolts
7	4' Complete Tine Pkg. (38pcs.)
7	5' Complete Tine Pkg. (42pcs.)
7	6' Complete Tine Pkg. (54pcs.)
8	Tine Bolt Pkg. (12 pcs.)
8	Tine Bolt Pkg. (72 pcs.)
8	Tine Bolt Pkg. (84 pcs.)
8	Tine Bolt Pkg. (108 pcs.)
9	Skid Assembly (left hand)
10	Skid Assembly (right hand)
11	Chain & Shackle Kit
12	Top Gearbox Assembly
13	Side Gearbox Assembly
14	Lift Pins CAT.#1(2pk)
15	Rotor Assembly
16	Back Plate Assembly
17	Frame Assembly
18	Outboard Hub Assembly
19	PTO Shaft

22" PTO SHAFT

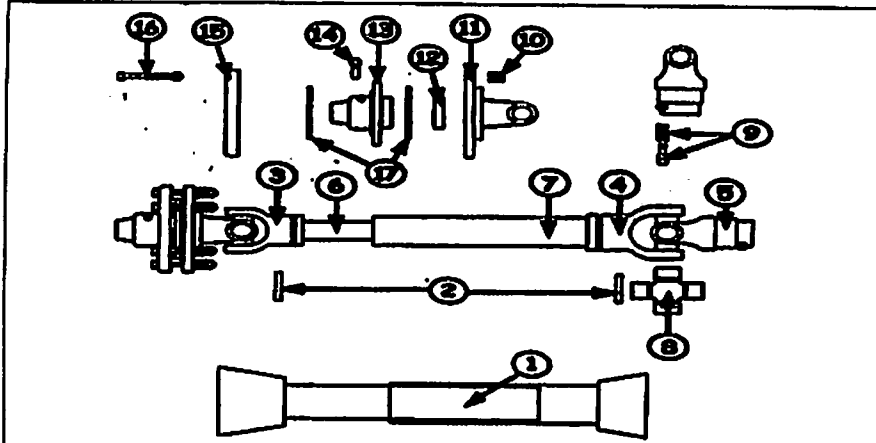

Ref. No.	Part Name
1	Safety Shield
2	Roll Pin
3	Male Tube End Yoke
4	Female Tube End Yoke
5	Tractor End Yoke
6	Inner Tube 14 Series
7	Outer Tube 14 Series
8	Cross Kit # 4
9	Quick Disconnect Pin
10	Clutch Spring w/ Compression Bolts & nuts (Pkg 8)
11	Flanged Yoke
12	Bushing
13	Friction Hub
14	10 x 70 Bolt
15	Pressure Plate (Outer)
16	Friction Disc for 6" Slip Clutch

OUTBOARD HUB ASSEMBLY

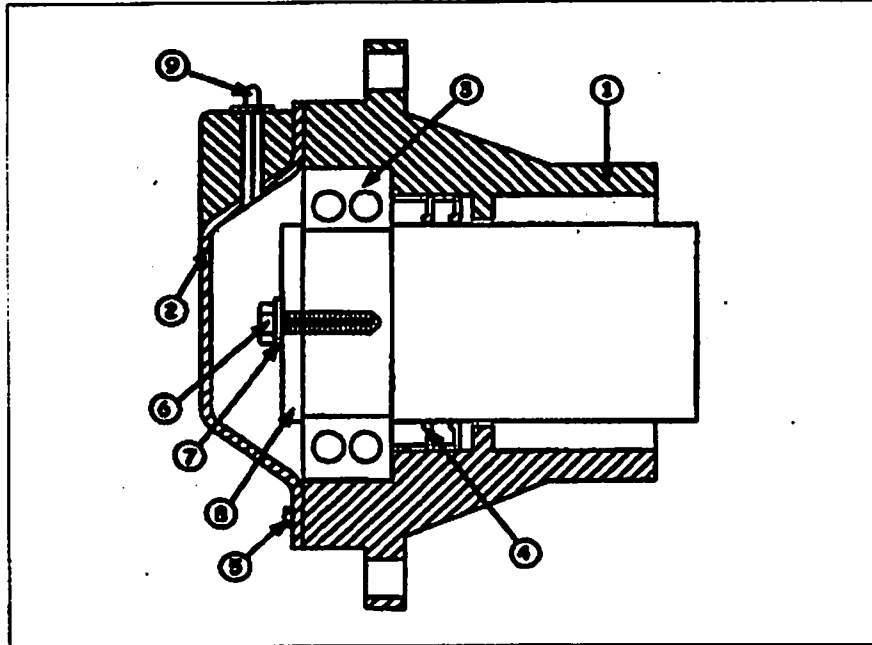

Ref. No.	Part Name
1	Hub Housing
2	Cap
3	Self Aligning Ball Bearing (1310)
4	Seal Double Lip (Pkg. 2)
5	Bolt M-6 -16
6	Bolt M-12 -25
7	Lock washer M-12
8	Washer
9	Grease Zerk 1/4"

SIDE GEARBOX ASSEMBLY

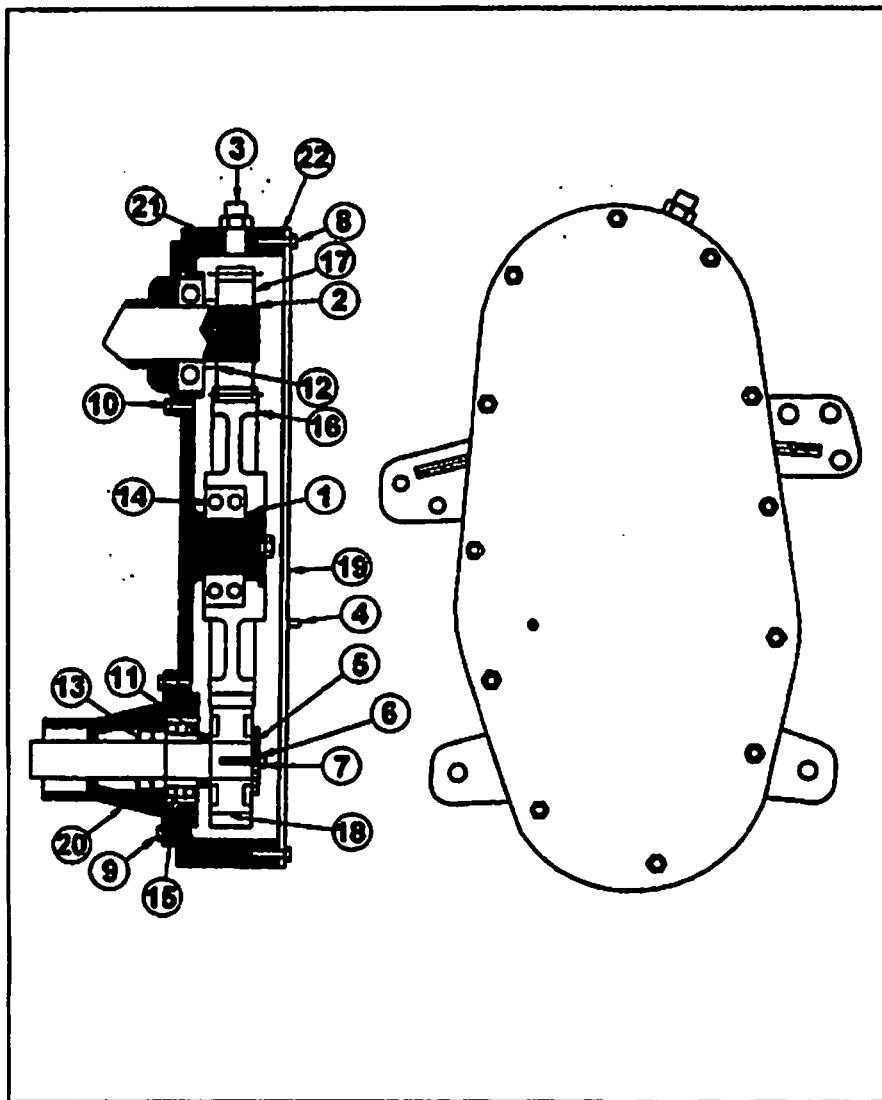

SIDE GEARBOX ASSEMBLY PARTS LIST

Ref. No.	Part Name
1	Retaining Ring 80mm
2	Retaining Ring 40mm
3	Pressure Plate Plug 1/2" - 14 NPT
4	Sq. Hd. Plug 1/4" - 18 NPT
5	Flat Washer (Main)
6	Lock washer M-12
7	Bolt M-12-25
8	Bolt M-8-16 (Pkg. 12)
9	Bolt M-10-25 (Pkg. 6)
10	Bolt M-10-20 (Pkg. 6)
11	Spacer (Output)
12	Spacer (Input)
13	Seal Double Lip (Pkg.2)
14	3210 Double Bearing (Ball)
15	1310 Self Aligning Bearing (Ball)
16	Gear -34 Teeth
17	Gear -16 Teeth
18	Gear -28 Teeth
19	Cover
20	Side Box Outboard Hub Housing
21	Housing
22	Gasket

TOP GEARBOX ASSEMBLY

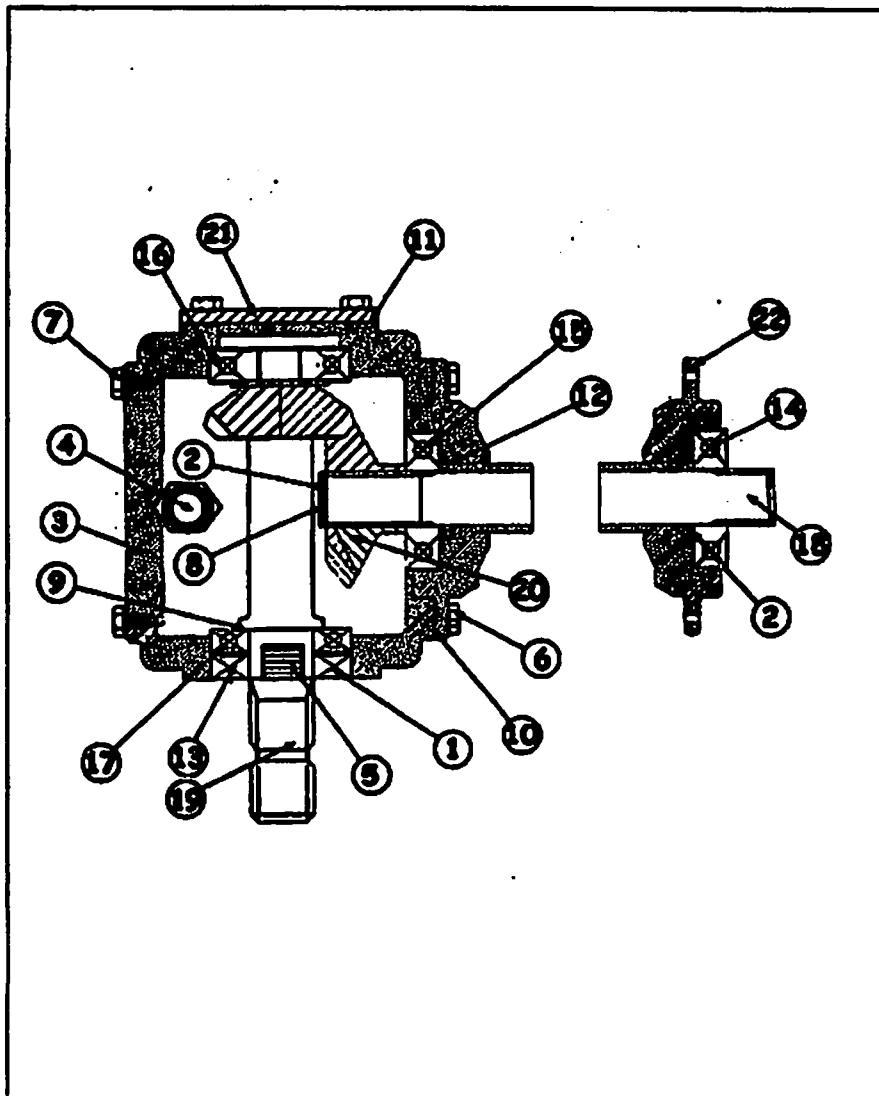

TOP GEARBOX ASSEMBLY PARTS LIST

Ref. No.	Part Name
1	Retaining Ring 72mm
2	Retaining Ring 40mm
3	Housing RTA - 50
4	Pressure Plate Plug 1/2" - 14 NPT
5	Sq. Hd. Plug 1/4" - 18 NPT
6	Bolt M-10-25 (Pkg. 6)
7	Bolt M-10-30 (Pkg. 4)
8	Spacer
9	Shim Pack (Pkg. 8)
10	Output Gasket 0.8mm
10	Output Gasket 0.5mm
11	Input Gasket 0.4mm
11	Input Gasket 0.2mm
12	Output Seal Double Lip
13	Input Seal Double Lip
14	Sealed Ball Bearing (6308)
15	Ball Bearing (6308)
16	Ball Bearing (6307)
17	Ball Bearing (6207)
18	Output Shaft TG-48 500mm
18	Output Shaft TG-60 700mm
18	Output Shaft TG-72 900mm
19	Pinion Shaft 13 Teeth
20	Output Gear 19 Teeth
21	Cap Blank
22	Cap Hub TG-48 500mm
22	Cap Hub TG-60 700mm
22	Cap Hub TG-72 900mm