

Assembly Instructions

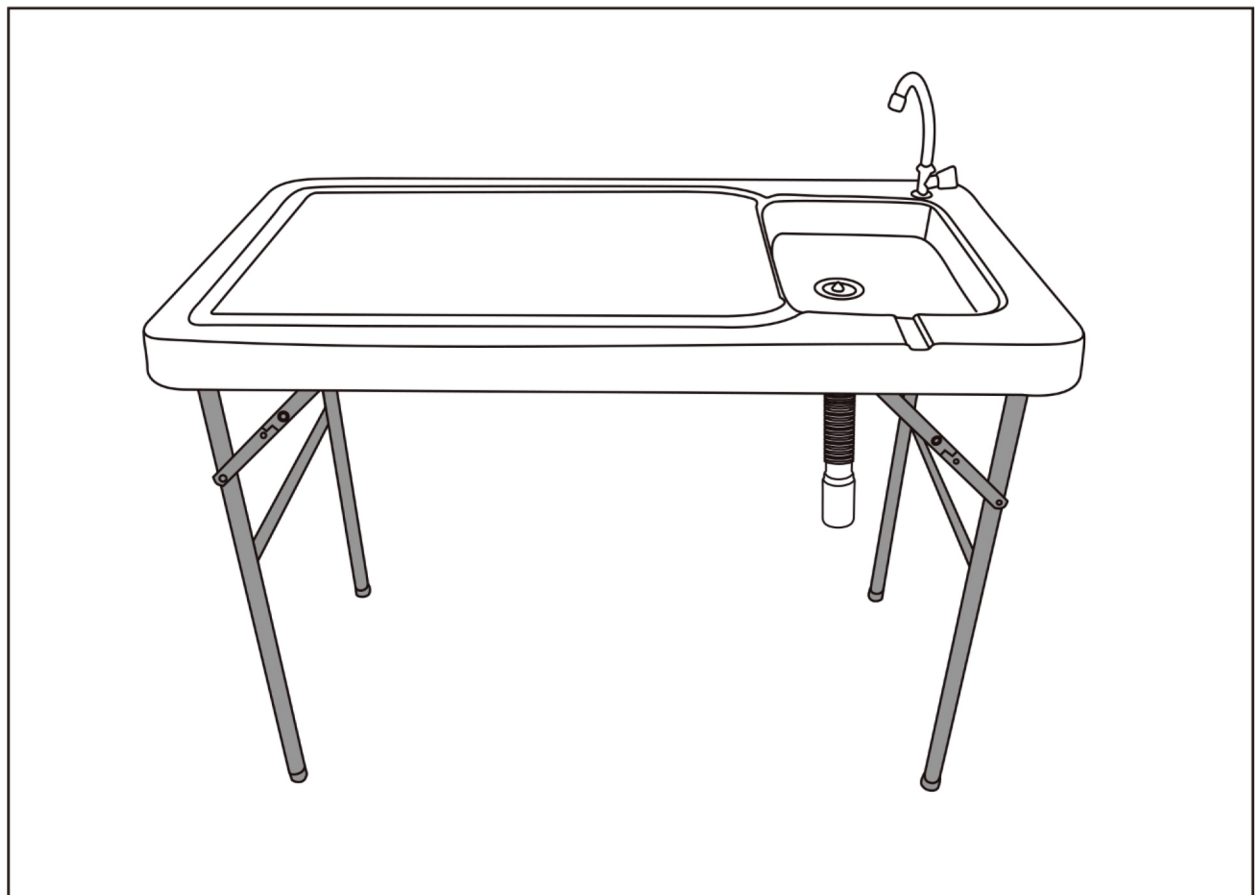

Parts Identification



table

1PC

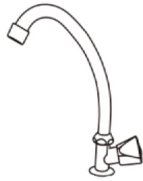

faucet

1PC



plastic nut

1PC



hose connection

1PC



long screw

1PC



metal drain

1PC



rubber washer

3PCS



plastic hose connection

1PC



plastic hose

1PC



bottom drain connection

1PC

Note: When assembling at least two adults are recommended.

Table Assembly: Remove sink from box and position on the ground as illustrated below in figure 1

Unfold each leg and lock into place as shown in figure 2

Note: Make sure legs are completely locked in position before use to prevent injury. A mallot may be used to lock the legs into place.

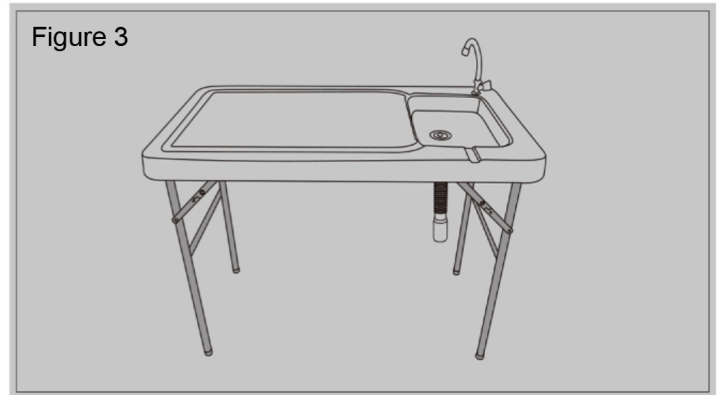
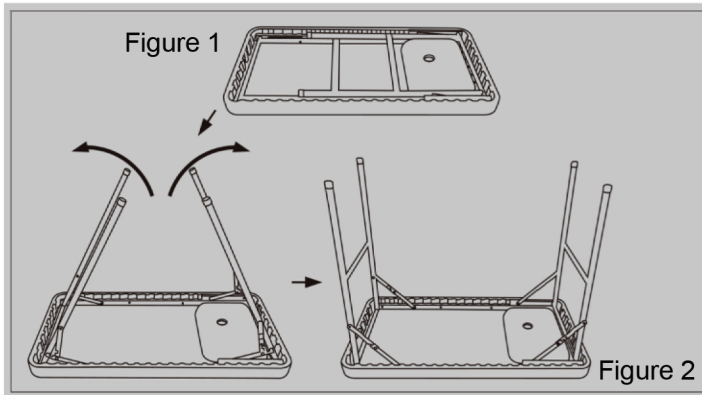

Faucet and Drain Assembly.

Step 1) Faucet connection: Connect faucet to plastic nut and then connect hose connection to plastic nut as shown in figure 1.

Step 2) Drain assembly: Connect long screw to metal drain and rubber washer as shown in figure 2.

Step 3) Drain connection: Connect rubber washer to bottom drain connection. Then assemble rubber washer to plastic hose connection. Assemble plastic hose to plastic hose connection as shown in figure 3 and figure 4.

Larger View:

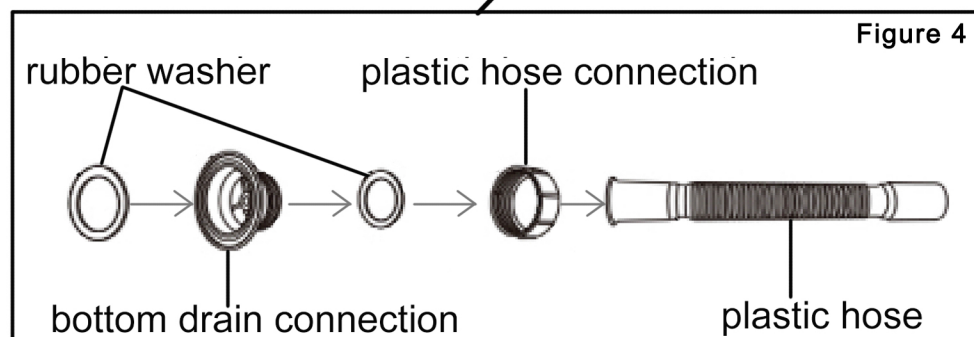
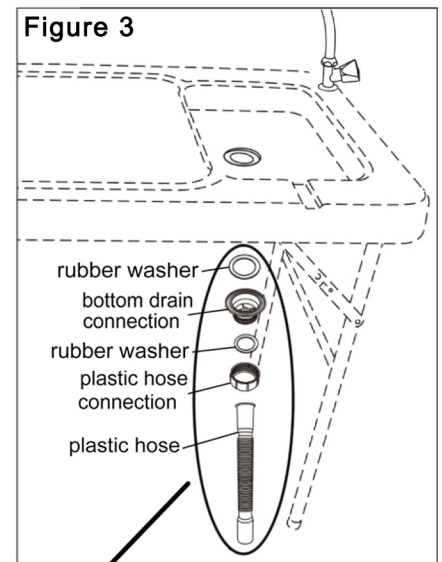
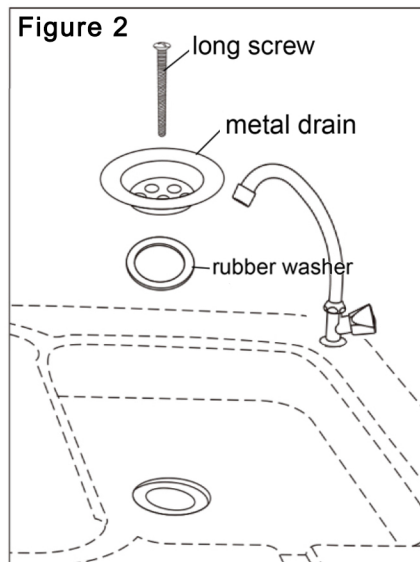
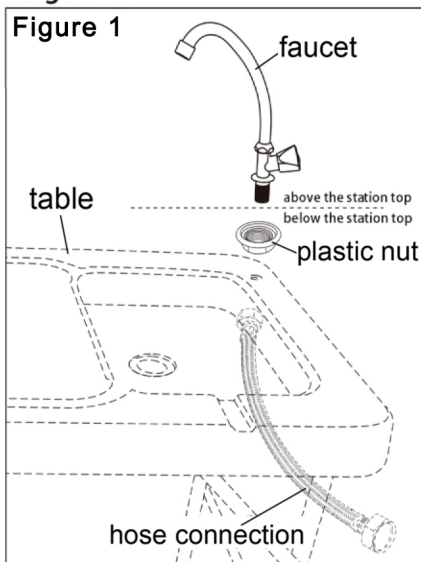

Made in China